

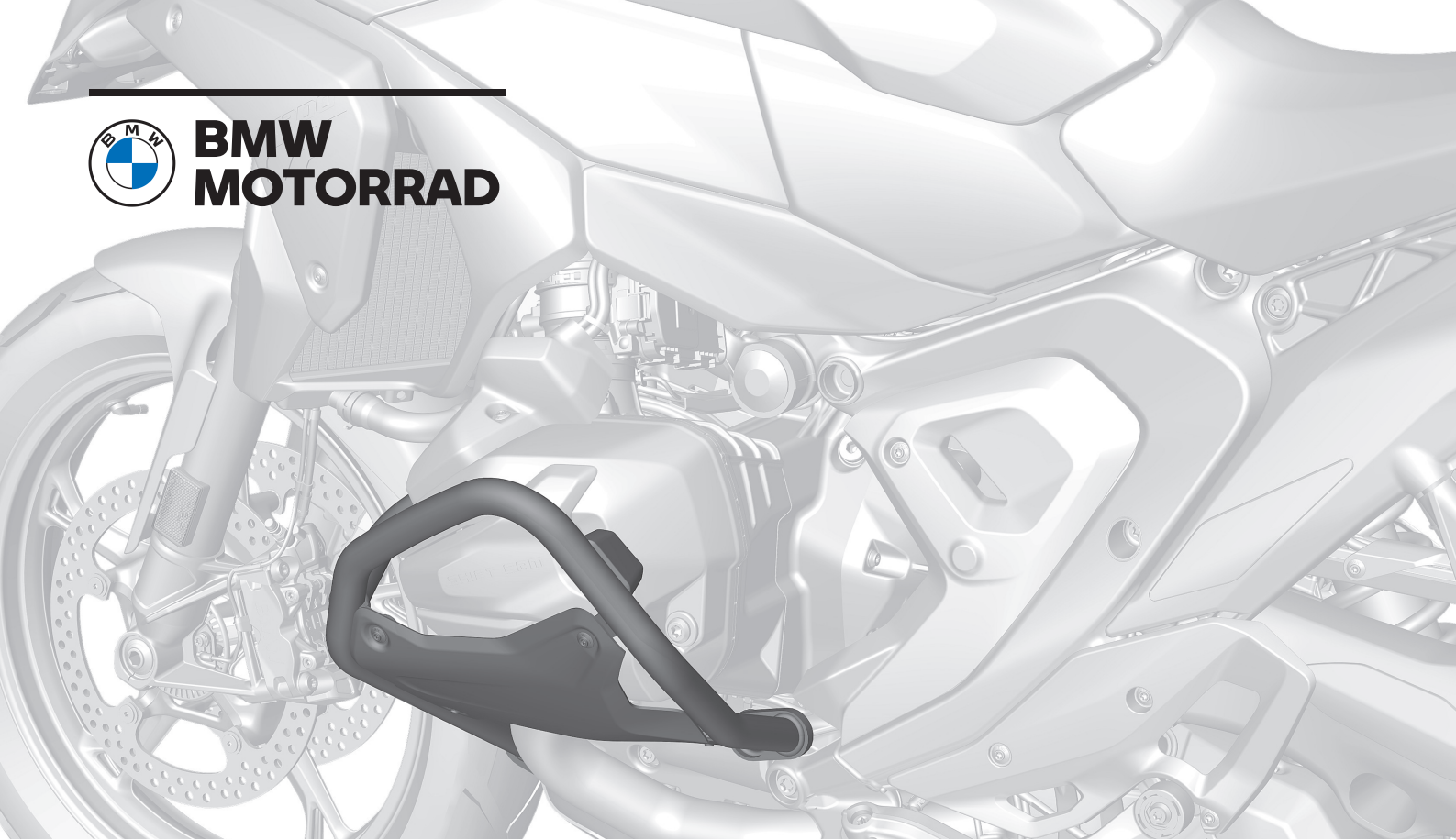

**BMW
MOTORRAD**



Installation instructions

ENGINE PROTECTION BAR

MAKE LIFE A RIDE

BEFORE COMMENCING WORK, YOU MUST READ THESE INSTALLATION INSTRUCTIONS THROUGH CAREFULLY AND MAKE SURE YOU UNDERSTAND THEM FULLY.

We congratulate you on your choice of optional accessories from BMW Motorrad that will enable you to customise your motorcycle in accordance with your personal preferences.

Safety is invariably an essential prerequisite for extracting full benefit and enjoyment from new accessories. Some work calls for special tools and possibly a thorough knowledge of motorcycle technology. If you are in doubt consult a specialist workshop, preferably your authorised BMW Motorrad dealer.

Since we provide you with a multitude of accessories and optional equipment, we cannot cover all equipment specifications in these installation instructions. Therefore we restrict ourselves to the basic version of the corresponding model. The removal and installation of other possibly installed accessories is described in the corresponding installation instructions. Consult your authorised BMW Motorrad dealer if you no longer have access to the sets of instructions you need.

If you have questions concerning your motorcycle or any of the accessories from our range, your authorised BMW Motorrad dealer will gladly provide advice and assistance.

We at BMW Motorrad hope you will enjoy riding your BMW and that all your journeys will be pleasant and safe.

THE SYMBOLS USED TO DRAW ATTENTION TO PRECAUTIONARY STATEMENTS IN THIS MANUAL ARE AS FOLLOWS:
 **CAUTION**

Low-risk hazard. Non-avoidance can lead to slight or moderate injury.

 **DANGER**

High-risk hazard. Non-avoidance leads to fatal or severe injury.

 **NOTICE**

Specific instructions on how to operate, control, adjust or look after items of equipment on the motorcycle.

- ▶ Start of the main activity
- ▷ Start of the secondary activity
- Instruction

 **WARNING**

Medium-risk hazard. Non-avoidance can lead to fatal or severe injury.

 **ATTENTION**

Special notes and precautionary measures. Non-compliance can lead to damage to the vehicle or accessory and, consequently, to voiding of the warranty.

 **Tightening torque**

Screws, bolts and nuts are tightened in accordance with the applicable DIN/ISO standards. Tightening torques that deviate from the standards are stated. Non-compliance can result in damage to the vehicle or accessories or can endanger the driver.

- ◀ End of the main activity
- ◁ End of the secondary activity
- ◇ End of validity designation CS (construction status), OE (optional extra) or OA (optional accessory)

All rights reserved.

Engine protection bar

Requisite tools

- Torx wrench set
- Torque wrench

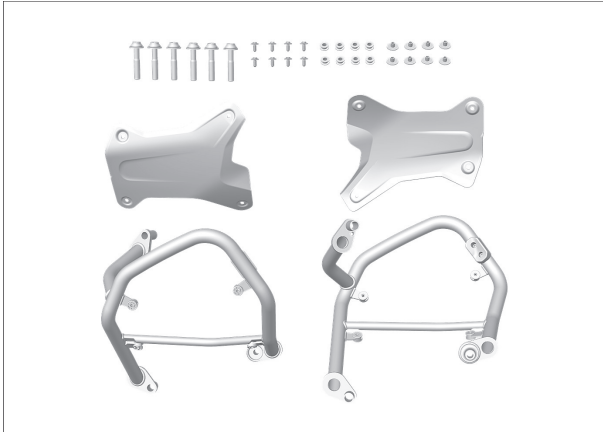

Scope of installation

- | | |
|-------------------------|----|
| – Engine protection bar | 2× |
| – Cover panel | 2× |
| – Bush | 8× |
| – rubber grommet | 8× |
| – Torx screws M5×16 | 8× |
| – Torx screws M8×55 | 6× |

General instructions

⚠ CAUTION

Hot engine and/or hot exhaust system

Risk of burn injury

- Allow engine and exhaust system to cool before starting work.

⚠ ATTENTION

Vehicle not securely propped

Risk of damage to parts if vehicle topples

- Prop the vehicle securely.

⚠ WARNING

Children and pets in the working area

Injury to persons

- Keep children and pets away from the working area.

⚠ CAUTION

Wearing jewellery during work

Risk of injury by snagging or electrical short circuit

- Remove all items of personal jewellery (rings, chains, wristwatch, etc.) before starting work.

⚠ NOTICE

Once the retrofit kit has been installed by the workshop, these installation instructions must be handed over to the customer.

Make sure that these installation instructions accompany the retrofit kit when it is passed on to a third party.

77 14 100 Installing the the engine protection bar

Additional work: 46 52 510 Mounting and dismounting the rear-wheel stand with special tools (for motorbikes without a centre stand)

1

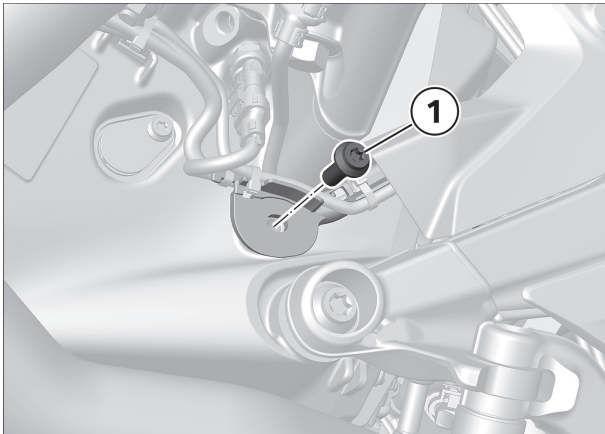

► **Preparation for engine protection bar**

- Remove screw (1).



2

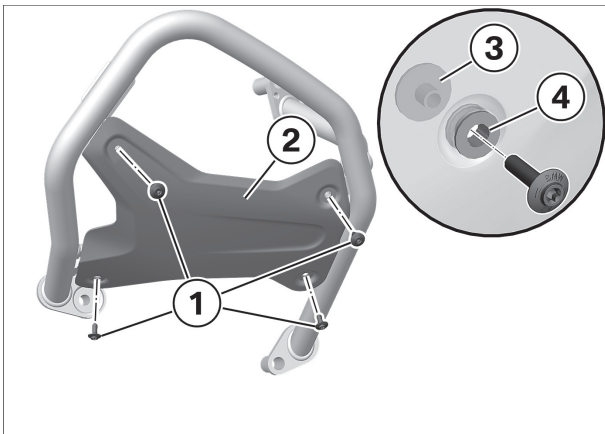

► **Installing trim for engine protection bar**

- Clean the threads.
- Position trim (2) on right engine protection bar, noting bush (3) and rubber grommet (4).
- Install screws (1).

 Tightening torques		
Trim to engine protection bar		
M5 x 14, Renew screw Thread-locking compound (micro-encapsulated)	5 Nm	

- Install left trim in the same way.



3

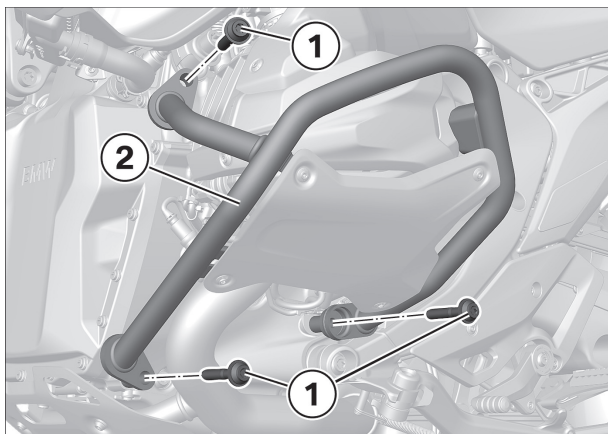

► **Installing left crash bar**

- Position engine protection bar (2).
- Install screws (1).

 Tightening torques		
Engine protection bar to engine		
M10 x 55	56 Nm	– with engine protection bars ^{OE} (0671)

4

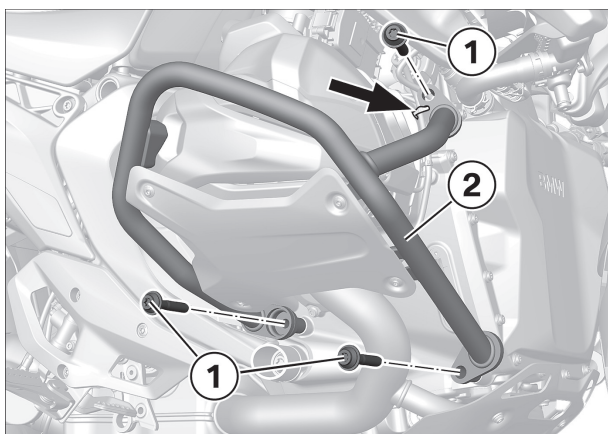

► **Install the right crash bar**

- Position engine protection bar (2).
- Install screws (1).

 Tightening torques		
Engine protection bar to engine		
M10 x 55	56 Nm	– with engine protection bars ^{OE} (0671)

- Secure the cable strap (arrow).

5

► **Final check of work performed**

- Check the following:
 - The work as performed achieved the intended purpose.
 - All reservoirs and containers have been filled and all fluids and lubricants are at their correct levels.
 - All threaded fasteners released beforehand have been correctly retightened.
 - The fuel system is free of leaks.
 - The lights and signalling equipment are fully operational and the vehicle is roadworthy.
 - The brake pads of the front and rear brakes are bedded against the brake discs.

▷ **Function test, engine start suppression**

Check

- Set kill switch to centred position.

- Select neutral.
- Switch on the ignition.
 - » Neutral indicator light "N" lights up.
- Select a gear.
 - » Neutral indicator light "N" goes out.
- Press the starter button.
 - » Starter does **not** operate.
- Extend the side stand.
- Pull the clutch lever.
- Press the starter button.
 - » Starter does **not** operate.
- Retract the side stand.
- Press the starter button without releasing the clutch lever.
 - » Starter operates.

Result

Not all test steps completed successfully.

Measure

- Check the appropriate parts with the BMW Motorrad diagnostic system.

