

# BMW Motorrad

## Installation instructions

### Rider's seat support set

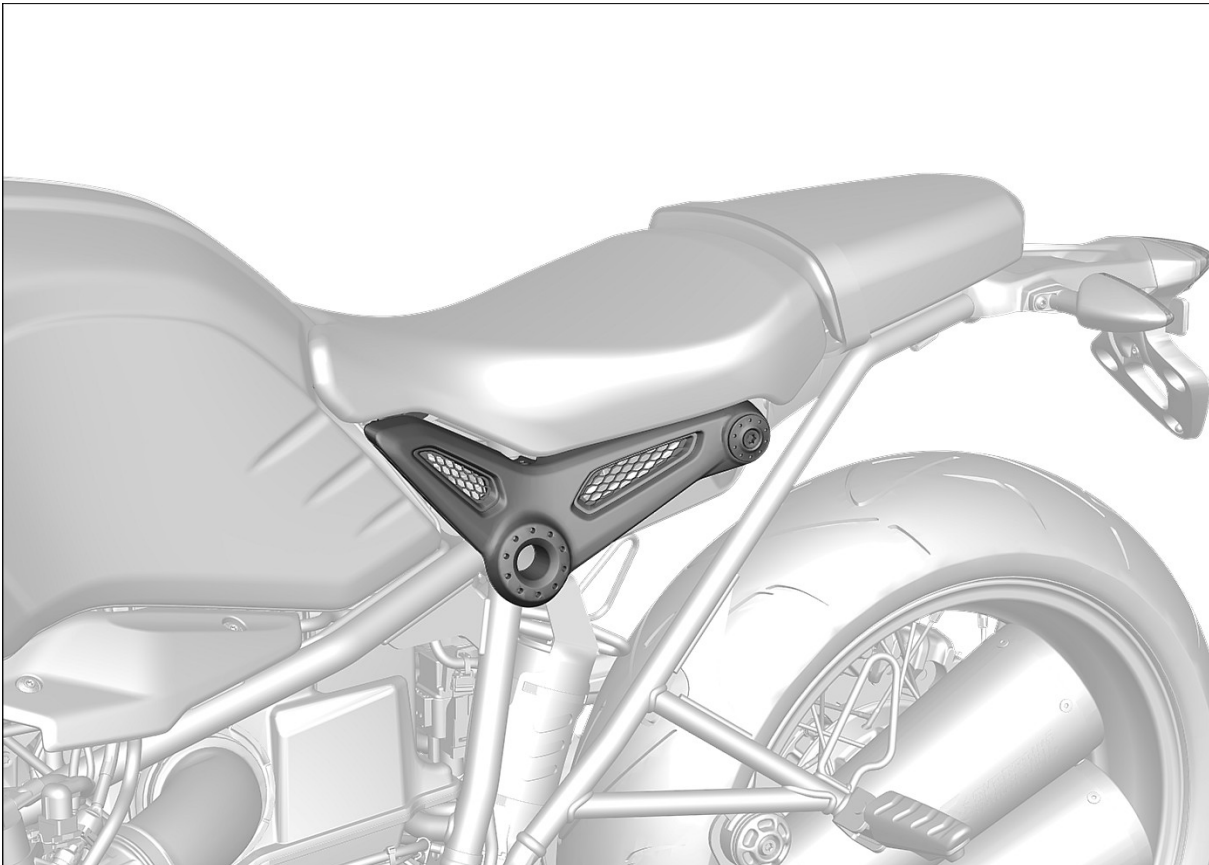

**Before commencing work, you must read these installation instructions through carefully and make sure you understand them fully.**

We congratulate you on your choice of optional accessories from BMW Motorrad that will enable you to customise your motorcycle in accordance with your personal preferences.

Safety is invariably an essential prerequisite for extracting full benefit and enjoyment from new accessories. Some work calls for special tools and possibly a thorough knowledge of motorcycle technology. If you are in doubt consult a specialist workshop, preferably your authorised BMW Motorrad dealer.

Since we provide you with a multitude of accessories and optional equipment, we cannot cover all equipment specifications in these installation instructions. Therefore we restrict ourselves to the basic version of the corresponding model. The removal and installation of other possibly installed accessories is described in the corresponding installation instructions. Consult your authorised BMW Motorrad dealer if you no longer have access to the sets of instructions you need.

If you have questions concerning your motorcycle or any of the accessories from our range, your authorised BMW Motorrad dealer will gladly provide advice and assistance.

We at BMW Motorrad hope you will enjoy riding your BMW and that all your journeys will be pleasant and safe.

#### **The symbols used to draw attention to precautionary statements in this manual are as follows:**

##### **CAUTION**

Low-risk hazard. Non-avoidance can lead to slight or moderate injury.

##### **WARNING**

Medium-risk hazard. Non-avoidance can lead to fatal or severe injury.

##### **DANGER**

High-risk hazard. Non-avoidance leads to fatal or severe injury.

##### **ATTENTION**

Special notes and precautionary measures. Non-compliance can lead to damage to the vehicle or accessory and, consequently, to voiding of the warranty.

##### **NOTICE**

Specific instructions on how to operate, control, adjust or look after items of equipment on the motorcycle.

##### **Tightening torque**

Screws, bolts and nuts are tightened in accordance with the applicable DIN/ISO standards. Tightening torques that deviate from the standards are stated. Non-compliance can result in damage to the vehicle or accessories or can endanger the driver.

- ▶ Start of the main activity
- ▷ Start of the secondary activity
- Instruction

- ◀ End of the main activity
- ◁ End of the secondary activity
- ◇ End of validity designation CS (construction status), OE (optional extra) or OA (optional accessory)

## Rider's seat support set

### Requisite tools

- Set of Torx bits
- Slotted screwdriver
- Torque wrench

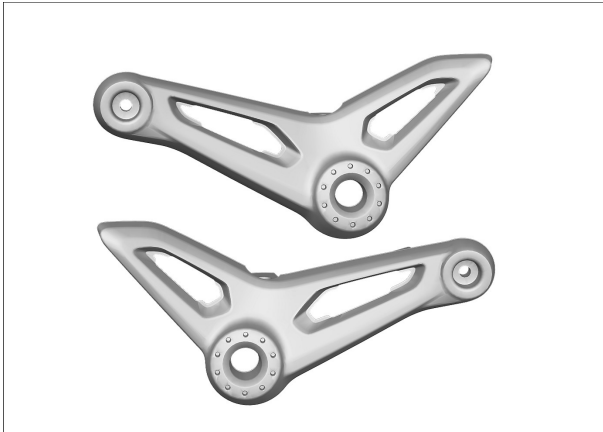

### Delivery specification

- |                              |   |
|------------------------------|---|
| – Holder, rider's seat left  | 1 |
| – Holder, rider's seat right | 1 |

### General instructions

#### **ATTENTION**

##### **Vehicle not securely propped**

Risk of damage to parts if vehicle topples

- Prop the vehicle securely.

#### **WARNING**

##### **Children and pets in the working area**

Injury to persons

- Keep children and pets away from the working area.

#### **CAUTION**

##### **Wearing jewellery during work**

Risk of injury by snagging or electrical short circuit

- Remove all items of personal jewellery (rings, chains, wristwatch, etc.) before starting work.

#### **NOTICE**

Once the retrofit kit has been installed by the workshop, these installation instructions must be handed over to the customer.

Make sure that these installation instructions accompany the retrofit kit when it is passed on to a third party.

## 77 25 023 Installing support for driver's seat

1

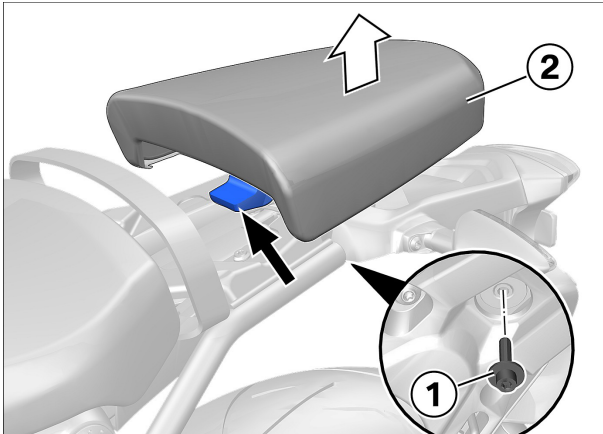

### ► Removing rear seat

- Remove screw (1).
- Raise rear seat (2) slightly at the rear and remove, noting the lug (arrow).



2

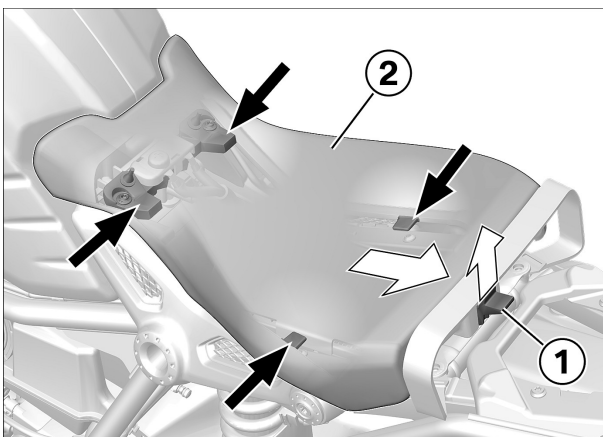

### ► Removing front seat

- Pull latch (1) up.
- Work front seat (2) to the rear and remove, noting the lugs (arrows).



3

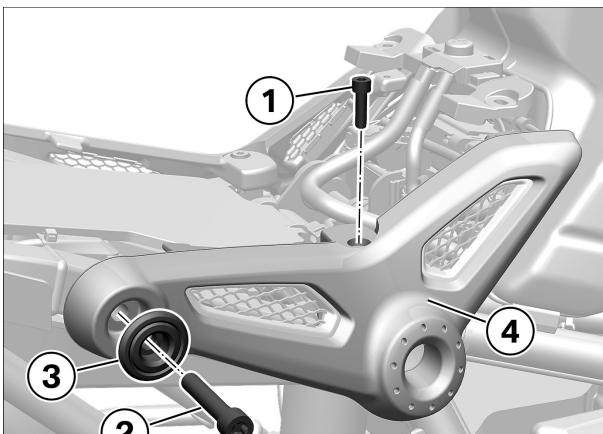

### ► Removing right rider's seat support

- Remove bolt (1).
- Remove screw (2) with spacer sleeve (3).
- Store components (1), (2) and (3) store (will be reused).
- Remove support for rider's seat (4).



## 4

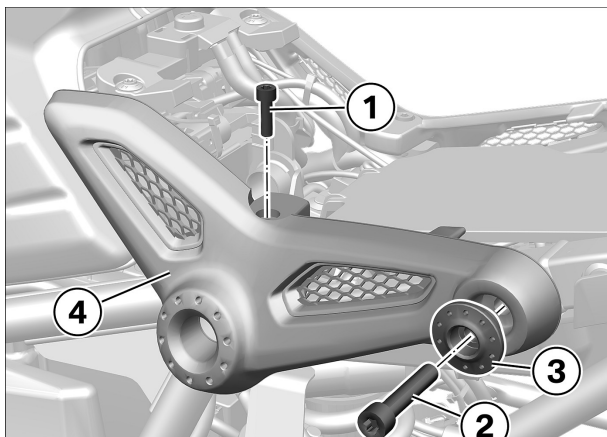

### ► Removing left rider's seat support

- Remove bolt (1).
- Remove screw (2) with spacer sleeve (3).
- Store components (1), (2) and (3) store (**will be reused**).
- Remove support for rider's seat (4).



## 5

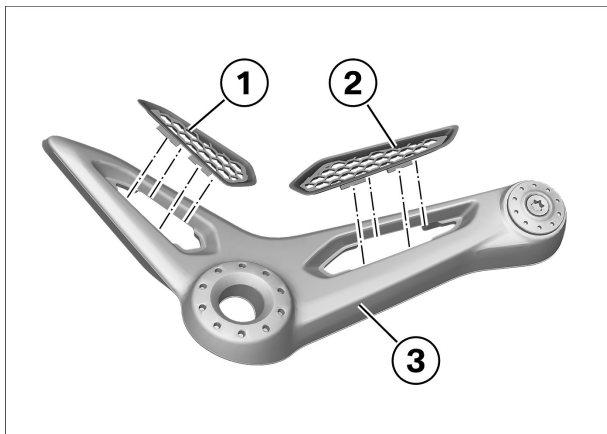

### ► Removing grid from carrier for rider's seat

- Remove front grid (1) and rear grid (2) from the left carrier for the rider's seat (3).
- Store grid (1) and (2) (**will be reused**).

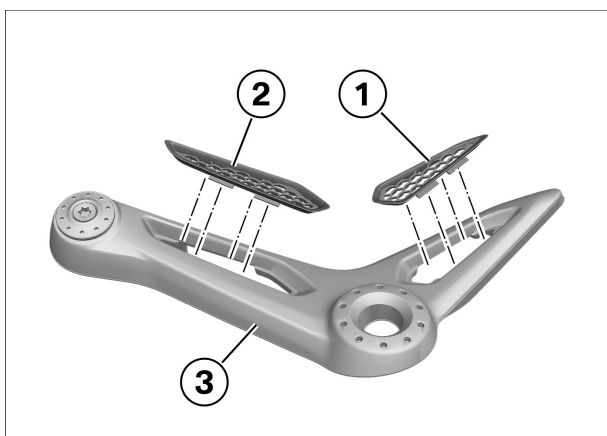

- Remove front grid (1) and rear grid (2) from the right carrier for the rider's seat (3).
- Store grid (1) and (2) (**will be reused**).



## 6

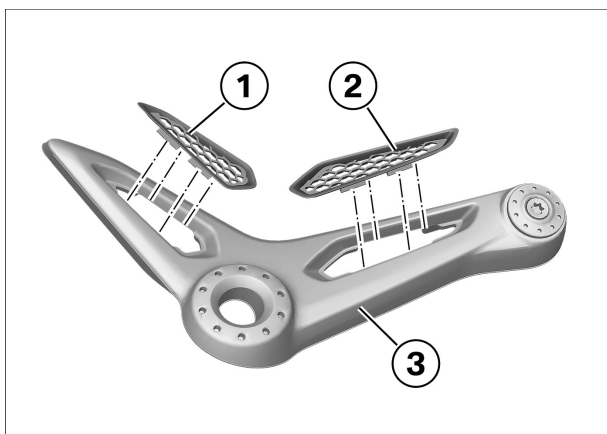

### ► Installing grid in rider's seat support

- Install front grid **(1)** and rear grid **(2)** in the left support for the rider's seat **(3)**.

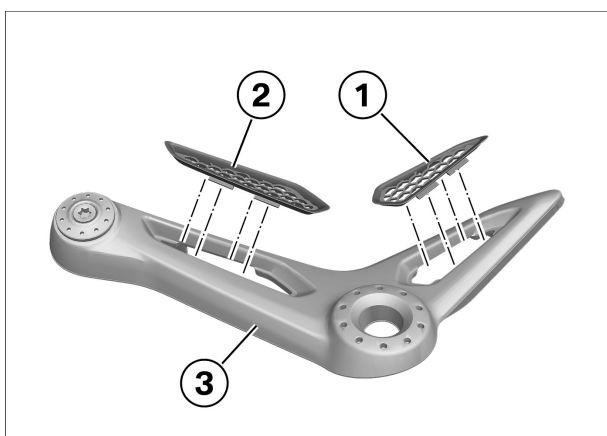

- Install front grid **(1)** and rear grid **(2)** in the right support for the rider's seat **(3)**.



## 7

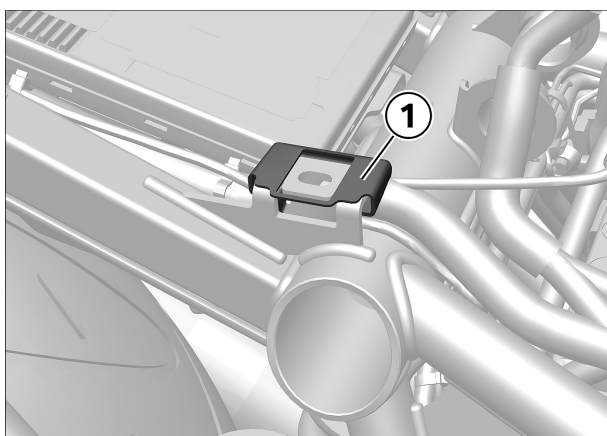

### ► Installing right rider's seat support

- Make sure abrasion protection **(1)** is fitted correctly.

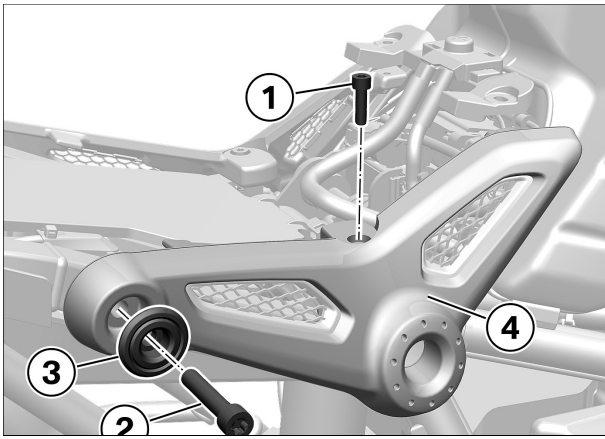

- Position support for rider's seat (4).
- Install screws (1) and screw (2) with spacer sleeve (3).

 Tightening torques		
Bracket for front seat to rear frame		
M6 x 20	8 Nm	
M8 x 40	19 Nm	

## 8

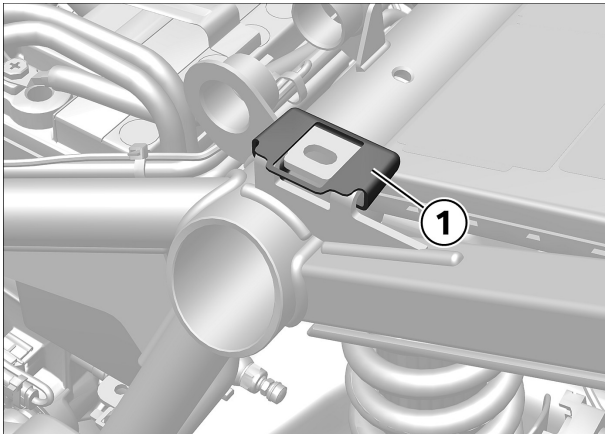

### ► Installing left rider's seat support

- Make sure abrasion protection (1) is fitted correctly.

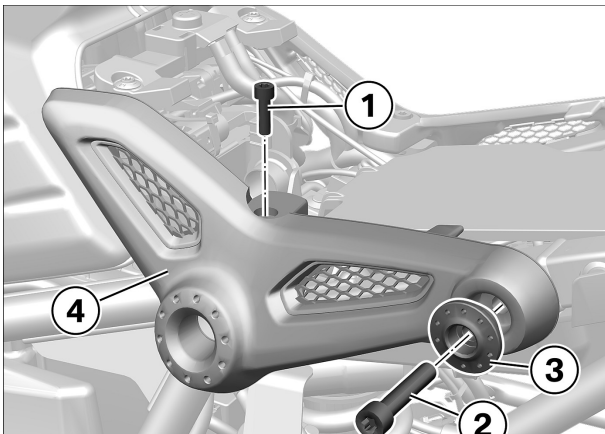

- Position support for rider's seat (4).
- Install screws (1) and screw (2) with spacer sleeve (3).

 Tightening torques		
Bracket for front seat to rear frame		
M6 x 20	8 Nm	
M8 x 40	19 Nm	

# 9

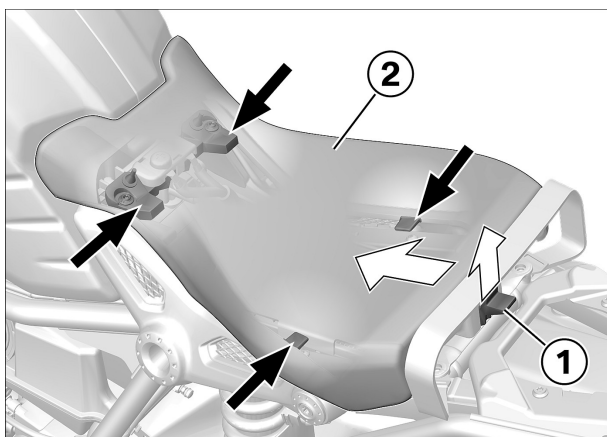

## ► Installing front seat

- Lift latch (1) and insert front seat (2), noting the lugs (arrows).
- Make sure that latch (1) is in the **bottom position**.

# 10

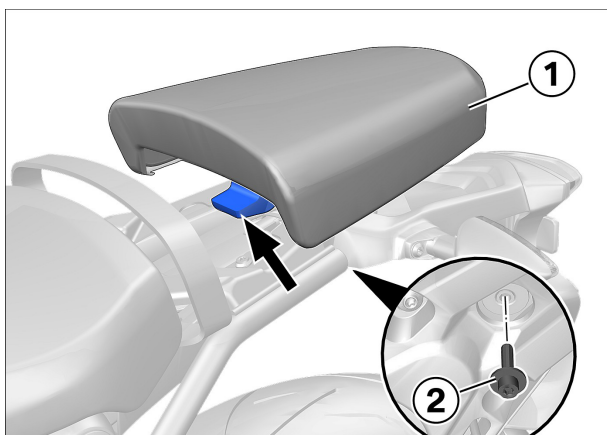

## ► Installing rear seat

- Hold rear seat (1) in position, noting the tab (arrow).
- Install screw (2).



### Tightening torques

#### Rear seat to number plate carrier

M6 x 25

3 Nm

# 11

## ► Final check of work performed

- Check the following:
  - The work as performed achieved the intended purpose.
  - All reservoirs and containers have been filled and all fluids and lubricants are at their correct levels.
  - All threaded fasteners released beforehand have been correctly retightened.
  - The fuel system is free of leaks.
  - The lights and signalling equipment are fully operational and the vehicle is roadworthy.
  - The brake pads of the front and rear brakes are bedded against the brake discs.

## ▷ Function test, engine start suppression

### Check

- Shift the transmission to idle position.



- Switch on the ignition.
- » Neutral indicator light "N" lights up.
- Select a gear.
- » Neutral indicator light "N" goes out.
- Operate the starter motor switch.
- » Starter does **not** operate.
- Extend the side stand.
- Pull the clutch lever.
- Operate the starter motor switch.
- » Starter does **not** operate.
- Retract the side stand.
- Operate the starter motor switch when the clutch is pulled.
- » Starter operates.

### **Result**

Not all test steps completed successfully.

### **Measure**

- Check the appropriate parts with the BMW Motorrad diagnostic system.

