

BMW Motorrad

Installation instructions

Rear silencer tapered

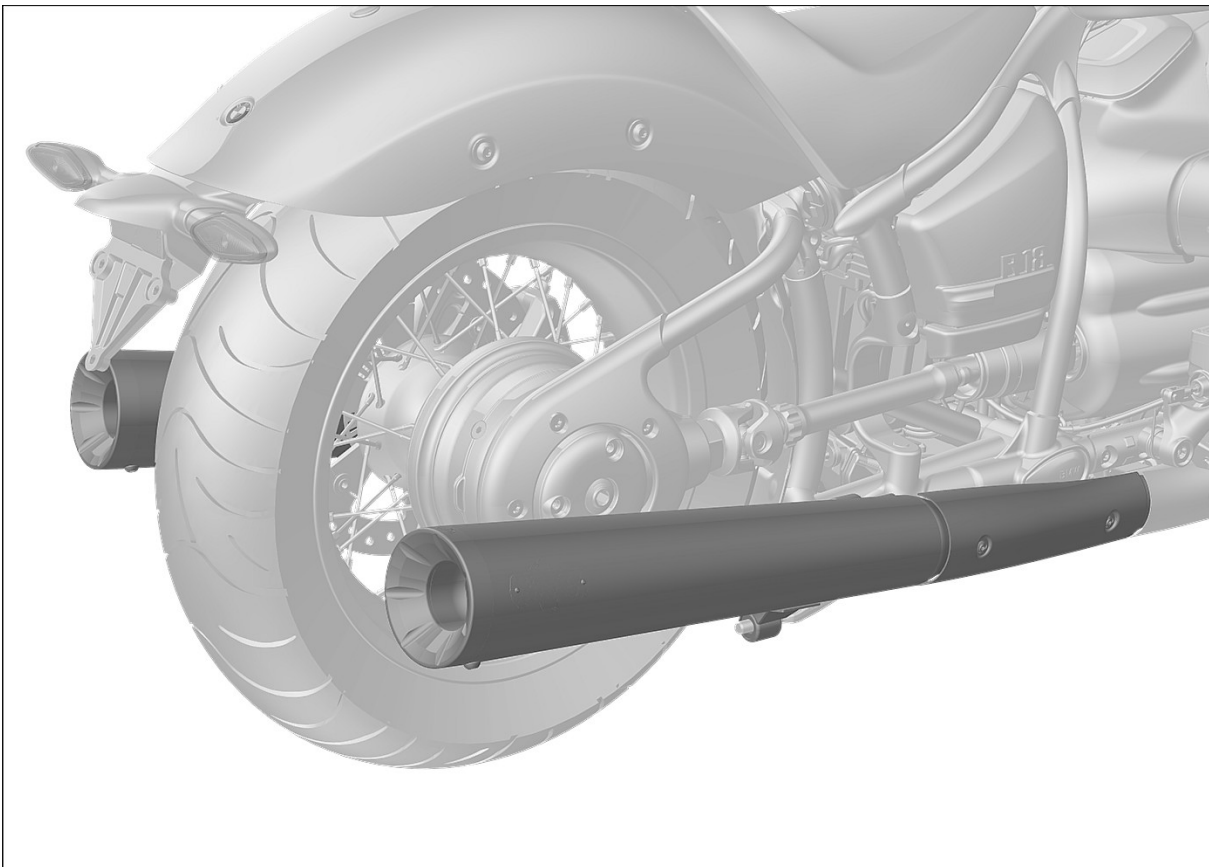

Before commencing work, you must read these installation instructions through carefully and make sure you understand them fully.

We congratulate you on your choice of optional accessories from BMW Motorrad that will enable you to customise your motorcycle in accordance with your personal preferences.

Safety is invariably an essential prerequisite for extracting full benefit and enjoyment from new accessories. Some work calls for special tools and possibly a thorough knowledge of motorcycle technology. If you are in doubt consult a specialist workshop, preferably your authorised BMW Motorrad dealer.

Since we provide you with a multitude of accessories and optional equipment, we cannot cover all equipment specifications in these installation instructions. Therefore we restrict ourselves to the basic version of the corresponding model. The removal and installation of other possibly installed accessories is described in the corresponding installation instructions. Consult your authorised BMW Motorrad dealer if you no longer have access to the sets of instructions you need.

If you have questions concerning your motorcycle or any of the accessories from our range, your authorised BMW Motorrad dealer will gladly provide advice and assistance.

We at BMW Motorrad hope you will enjoy riding your BMW and that all your journeys will be pleasant and safe.

The symbols used to draw attention to precautionary statements in this manual are as follows:



CAUTION

Low-risk hazard. Non-avoidance can lead to slight or moderate injury.



WARNING

Medium-risk hazard. Non-avoidance can lead to fatal or severe injury.



DANGER

High-risk hazard. Non-avoidance leads to fatal or severe injury.



ATTENTION

Special notes and precautionary measures. Non-compliance can lead to damage to the vehicle or accessory and, consequently, to voiding of the warranty.



NOTICE

Specific instructions on how to operate, control, adjust or look after items of equipment on the motorcycle.



Tightening torque

Screws, bolts and nuts are tightened in accordance with the applicable DIN/ISO standards. Tightening torques that deviate from the standards are stated. Non-compliance can result in damage to the vehicle or accessories or can endanger the driver.

► Start of the main activity

▷ Start of the secondary activity

• Instruction

◄ End of the main activity

◁ End of the secondary activity

◇ End of validity designation CS (construction status), OE (optional extra) or OA (optional accessory)

© 2020 Bayerische Motoren Werke Aktiengesellschaft
80788 Munich, Germany

Not to be reproduced by any means whatsoever, wholly or in part, without the written permission of BMW Motorrad, After Sales.

Printed in Germany.

Subject to change without notice. Errors and omissions excepted.

All rights reserved.

Rear silencer tapered

Requisite tools

- Set of Torx bits
- Set of hexagon socket bits
- Torque wrench

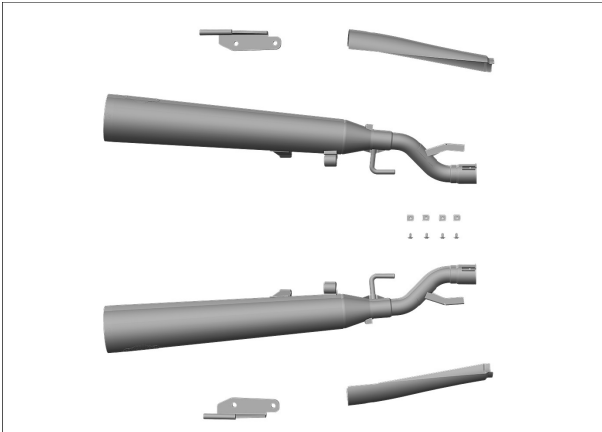

Delivery specification

- Rear silencer set

General instructions

ATTENTION

Vehicle not securely propped

Risk of damage to parts if vehicle topples

- Prop the vehicle securely.

CAUTION

Hot engine and/or hot exhaust system

Risk of burn injury

- Allow engine and exhaust system to cool before starting work.

WARNING

Children and pets in the working area

Injury to persons

- Keep children and pets away from the working area.

CAUTION

Wearing jewellery during work

Risk of injury by snagging or electrical short circuit

- Remove all items of personal jewellery (rings, chains, wristwatch, etc.) before starting work.

NOTICE

Once the retrofit kit has been installed by the workshop, these installation instructions must be handed over to the customer.

Make sure that these installation instructions accompany the retrofit kit when it is passed on to a third party.

77 11 013 Installing silencer

Additional work: 46 52 510 Removing and installing the rear-wheel stand special tool (motorcycles without centre stand)

1

► Removing left silencer

⚠ CAUTION

Hot exhaust system

Risk of burn injury

- Do not touch a hot exhaust system.

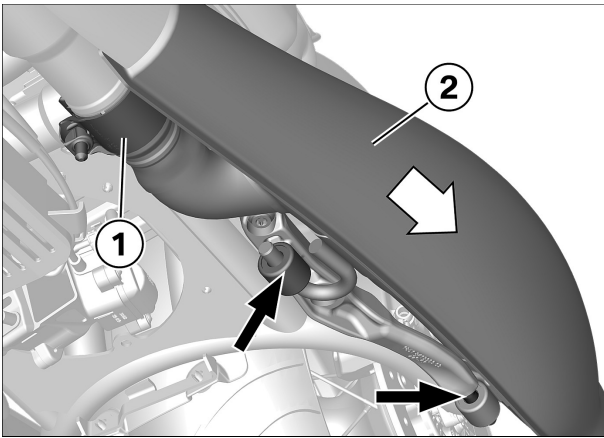

- Slacken the clamp (1).
- Detach silencer (2) to the rear from holder (Arrows) and remove.
- Remove clamp (1) from silencer (2) and store, **will be used again**.



2

► Installing additional bracket for left silencer

- Remove screws (1).
- Remove silencer support (2) from frame (3) and store, **will be reused**.

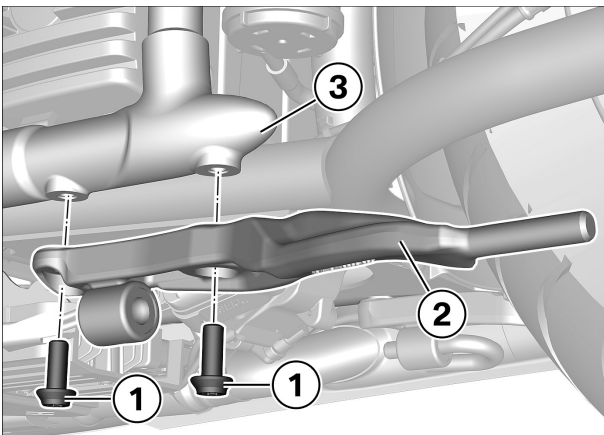

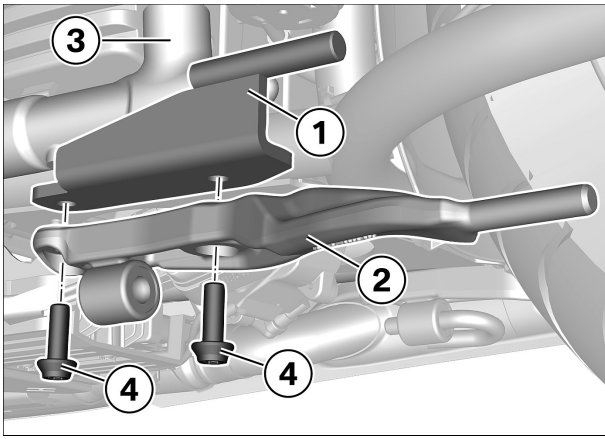

- Install rear brake pads and spring.
- Position additional bracket **(1)** together with silencer support **(2)** on frame **(3)**.
- Install screws **(4)**.

|  Tightening torques | | |
|---|-------|--|
| Additional bracket for silencer to frame | | |
| M10 x 30, Renew screw | 38 Nm | |
| Thread-locking compound (micro-encapsulated) | | |

3

► Installing new left silencer

NOTICE

To ensure the leaktightness of the exhaust system, the exhaust clamps have to be lubricated for installation. It is particularly important to apply lubricant to the vicinity of the joint.

- Clean clamp **(1)** **inside** and lubricate lightly.

|  Lubricant | |
|--|-----------------|
| Optimoly TA | 18 21 9 062 599 |

- Slide clamp **(1)** onto new silencer **(2)** and align with retaining lug **(arrow)**.

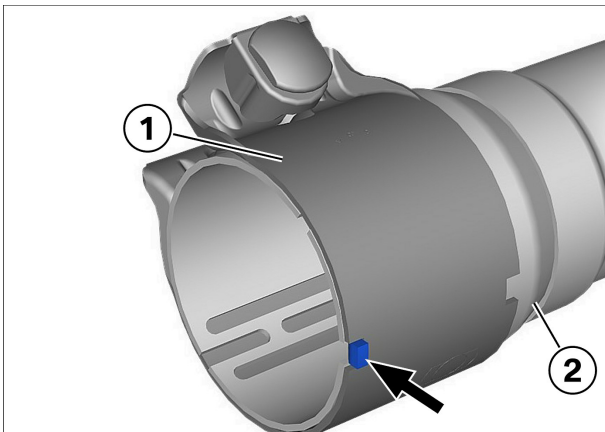

- Install new silencer **(1)** sliding it forward into the holder **(arrows)** and attaching it on additional bracket **(2)**.
- Tighten the clamp **(3)**.

|  Tightening torques | | |
|---|-------|--|
| Clamp to silencer and exhaust manifold | | |
| | 24 Nm | |

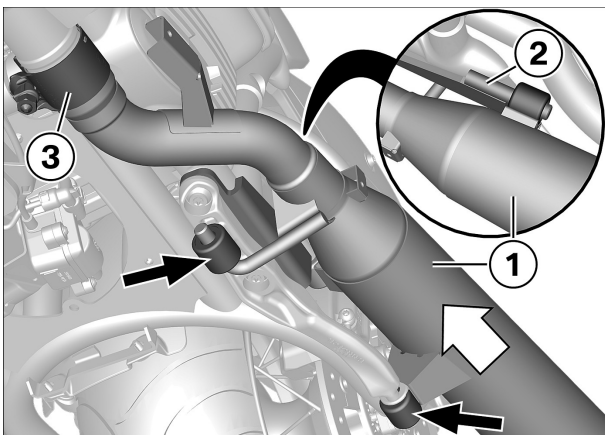

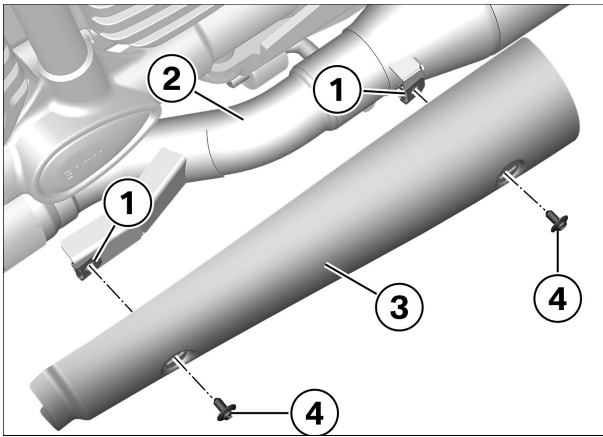

- Install flat nuts (1) on new silencer (2), position trim (3) and install bolts (4).

| Tightening torques | | |
|--------------------|------|--|
| Cover to silencer | | |
| M5 x 10 | 2 Nm | |

4

► Removing right silencer

⚠ CAUTION

Hot exhaust system

Risk of burn injury

- Do not touch a hot exhaust system.

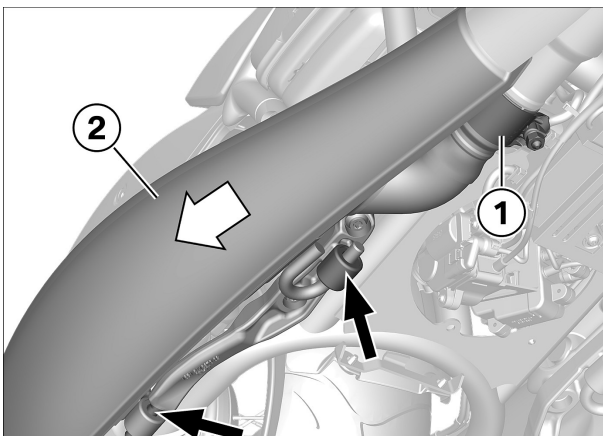

- Slacken the clamp (1).
- Detach silencer (2) to the rear from holder (Arrows) and remove.
- Remove clamp (1) from silencer (2) and store, **will be used again**.

5

► Installing additional bracket for right silencer

- Remove screws (1).
- Remove silencer support (2) from frame (3) and store, **will be reused**.

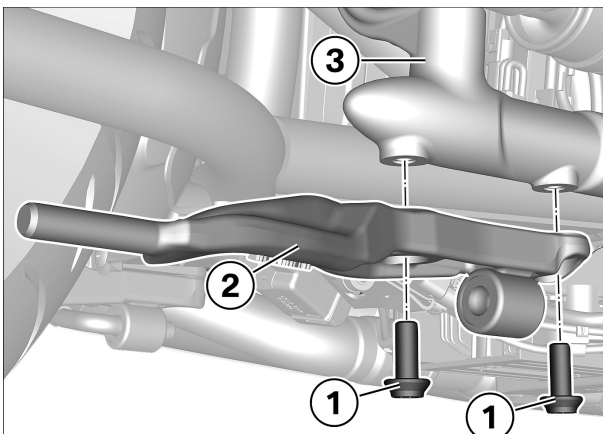

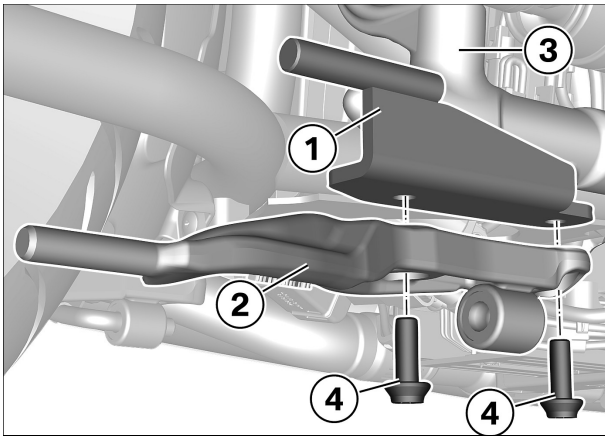

- Install rear brake pads and spring.
- Position additional bracket **(1)** together with silencer support **(2)** on frame **(3)**.
- Install screws **(4)**.

| Tightening torques | | |
|---|-------|--|
| Additional bracket for silencer to frame | | |
| M10 x 30, Renew screw | 38 Nm | |
| Thread-locking compound (micro-encapsulated) | | |

6

► Installing new right silencer

NOTICE

To ensure the leaktightness of the exhaust system, the exhaust clamps have to be lubricated for installation. It is particularly important to apply lubricant to the vicinity of the joint.

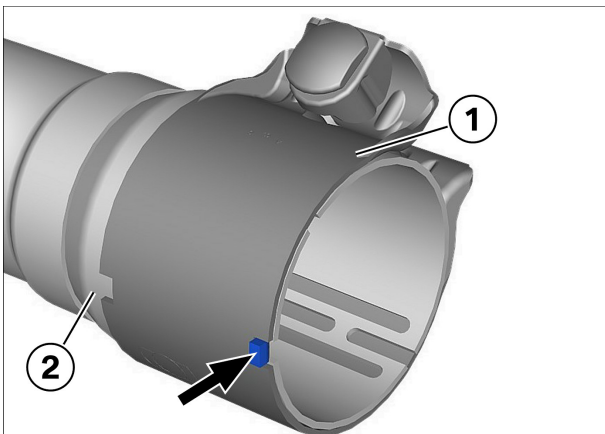

- Clean clamp **(1)** **inside** and lubricate lightly.

| Lubricant | |
|-------------|-----------------|
| Optimoly TA | 18 21 9 062 599 |

- Slide clamp **(1)** onto new silencer **(2)** and align with retaining lug **(arrow)**.

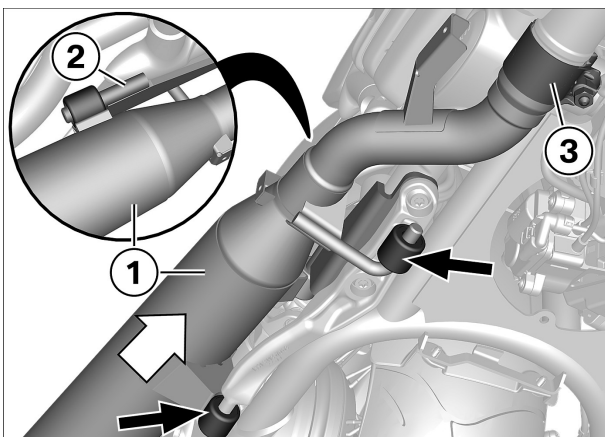

- Install new silencer **(1)** sliding it forward into the holder **(arrows)** and attaching it on additional bracket **(2)**.
- Tighten the clamp **(3)**.

| Tightening torques | | |
|---|-------|--|
| Clamp to silencer and exhaust manifold | | |
| | 24 Nm | |

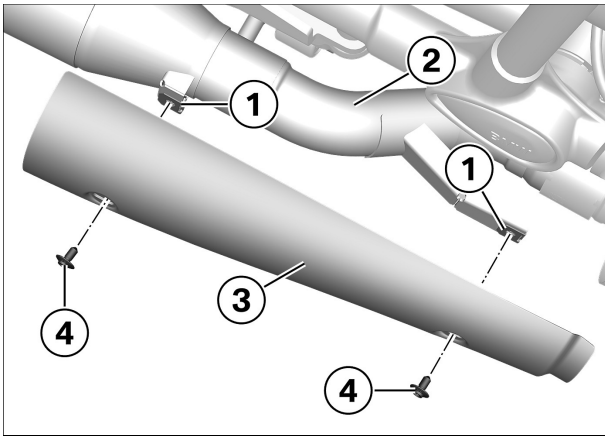

- Install flat nuts (1) on new silencer (2), position trim (3) and install bolts (4).

| Tightening torques | | |
|--------------------------|------|--|
| Cover to silencer | | |
| M5 x 10 | 2 Nm | |

7

► Final check of work performed

- Check the following:
 - The work as performed achieved the intended purpose.
 - All reservoirs and containers have been filled and all fluids and lubricants are at their correct levels.
 - All threaded fasteners released beforehand have been correctly retightened.
 - The fuel system is free of leaks.
 - The lights and signalling equipment are fully operational and the vehicle is roadworthy.
 - The brake pads of the front and rear brakes are bedded against the brake discs.

▷ Function test, engine start suppression

Check

- Select neutral.
 - » Neutral indicator light "N" lights up.
- Select a gear.
 - » Neutral indicator light "N" goes out.
- Operate the starter switch.
 - » Starter does **not** operate.
- Extend the side stand.
- Pull the clutch lever.
- Operate the starter switch.
 - » Starter does **not** operate.
- Retract the side stand.
- Operate the starter switch without releasing the clutch lever.
 - » Starter operates.

Result

Not all test steps completed successfully.

Measure

- Check the appropriate parts with the BMW Motorrad diagnostic system.

