

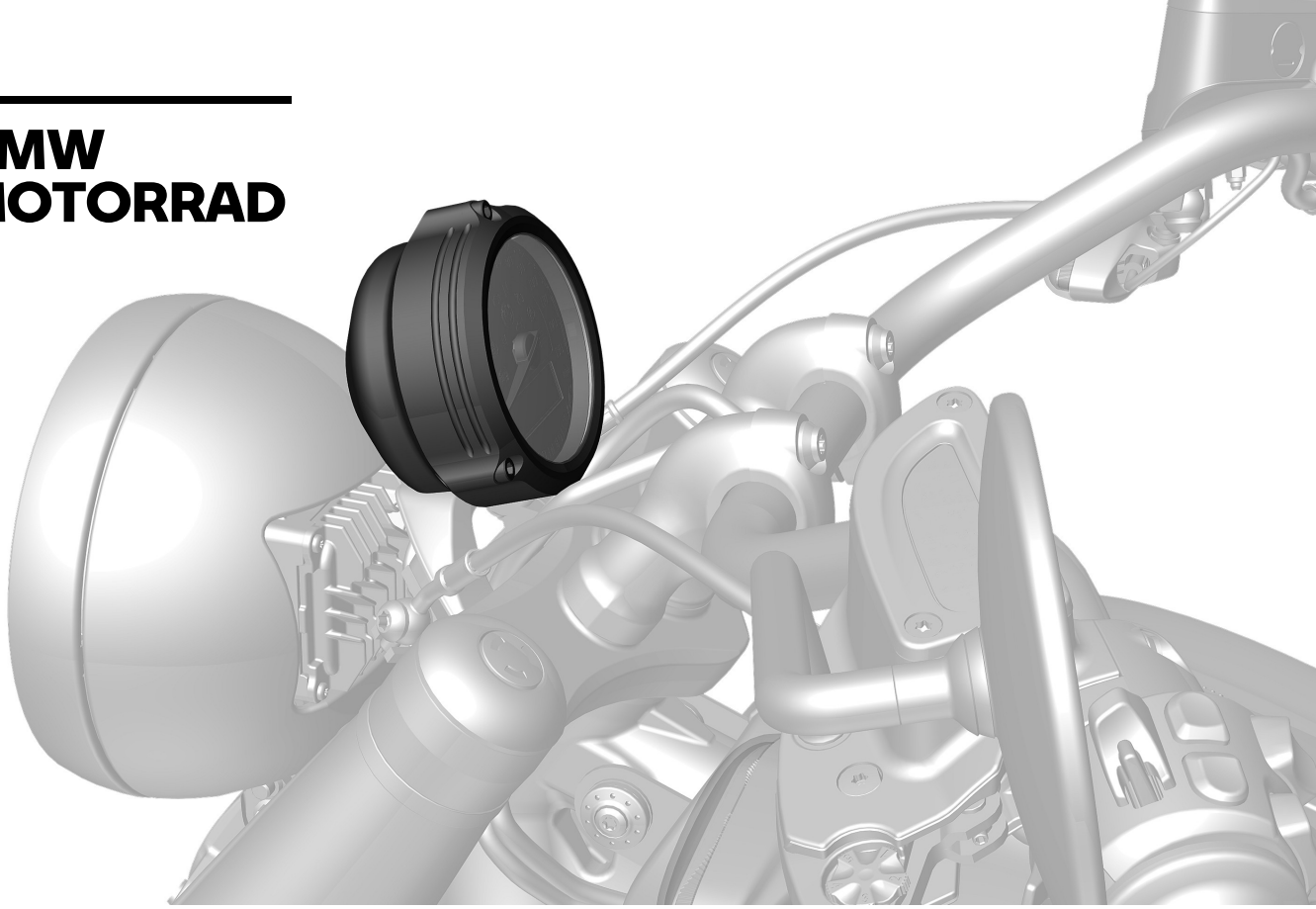

**BMW
MOTORRAD**



Installation instructions

SPEEDOMETER HOUSING

MAKE LIFE A RIDE

BEFORE COMMENCING WORK, YOU MUST READ THESE INSTALLATION INSTRUCTIONS THROUGH CAREFULLY AND MAKE SURE YOU UNDERSTAND THEM FULLY.

We congratulate you on your choice of optional accessories from BMW Motorrad that will enable you to customise your motorcycle in accordance with your personal preferences.

Safety is invariably an essential prerequisite for extracting full benefit and enjoyment from new accessories. Some work calls for special tools and possibly a thorough knowledge of motorcycle technology. If you are in doubt consult a specialist workshop, preferably your authorised BMW Motorrad dealer.

Since we provide you with a multitude of accessories and optional equipment, we cannot cover all equipment specifications in these installation instructions. Therefore we restrict ourselves to the basic version of the corresponding model. The removal and installation of other possibly installed accessories is described in the corresponding installation instructions. Consult your authorised BMW Motorrad dealer if you no longer have access to the sets of instructions you need.

If you have questions concerning your motorcycle or any of the accessories from our range, your authorised BMW Motorrad dealer will gladly provide advice and assistance.

We at BMW Motorrad hope you will enjoy riding your BMW and that all your journeys will be pleasant and safe.

THE SYMBOLS USED TO DRAW ATTENTION TO PRECAUTIONARY STATEMENTS IN THIS MANUAL ARE AS FOLLOWS:
 **CAUTION**

Low-risk hazard. Non-avoidance can lead to slight or moderate injury.

 **DANGER**

High-risk hazard. Non-avoidance leads to fatal or severe injury.

 **NOTICE**

Specific instructions on how to operate, control, adjust or look after items of equipment on the motorcycle.

- ▶ Start of the main activity
- ▷ Start of the secondary activity
- Instruction

 **WARNING**

Medium-risk hazard. Non-avoidance can lead to fatal or severe injury.

 **ATTENTION**

Special notes and precautionary measures. Non-compliance can lead to damage to the vehicle or accessory and, consequently, to voiding of the warranty.

 **Tightening torque**

Screws, bolts and nuts are tightened in accordance with the applicable DIN/ISO standards. Tightening torques that deviate from the standards are stated. Non-compliance can result in damage to the vehicle or accessories or can endanger the driver.

- ◀ End of the main activity
- ◁ End of the secondary activity
- ◇ End of validity designation CS (construction status), OE (optional extra) or OA (optional accessory)

All rights reserved.

Speedometer housing

Requisite tools

- Torx wrench set
- Hexagon socket wrench set
- Torque wrench



Scope of installation

- Set for speedometer housing

General instructions

ATTENTION

Vehicle not securely propped

Risk of damage to parts if vehicle topples

- Prop the vehicle securely.

WARNING

Children and pets in the working area

Injury to persons

- Keep children and pets away from the working area.

CAUTION

Wearing jewellery during work

Risk of injury by snagging or electrical short circuit

- Remove all items of personal jewellery (rings, chains, wristwatch, etc.) before starting work.

NOTICE

Once the retrofit kit has been installed by the workshop, these installation instructions must be handed over to the customer.

Make sure that these installation instructions accompany the retrofit kit when it is passed on to a third party.

77 52 013 Installing the instrument cluster housing

Additional work: 46 52 510 Mounting and dismounting the rear-wheel stand with special tools (for motorbikes without a centre stand)

1

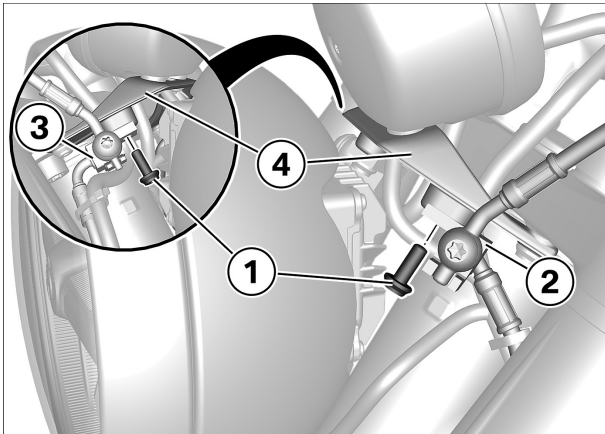

► Disconnecting clutch and brake line

- Remove screws (1).
- Disconnect clutch line (2) and brake line (3) from holder (4) for instrument cluster.



2

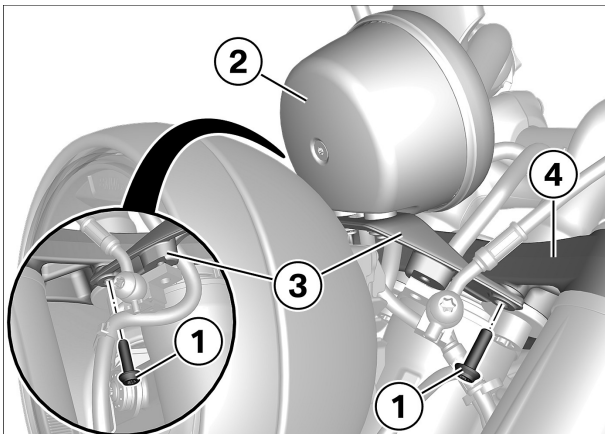

► Disengaging instrument cluster with holder

- Remove screws (1).
- Disengage instrument cluster (2) with holder (3) from fork bridge (4).



3

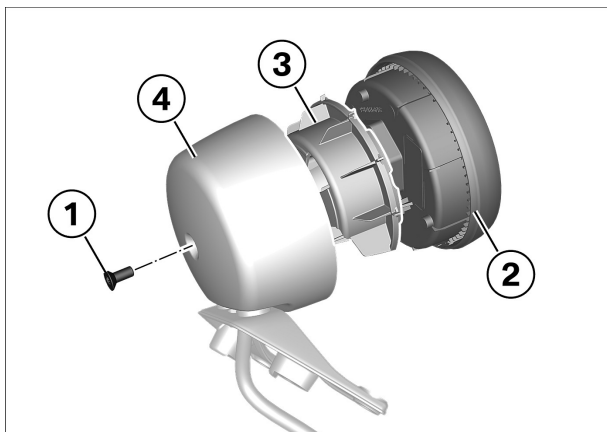

► Removing instrument panel

- Remove bolt (1).
- Disengage instrument cluster (2) with internal holder (3) from instrument pan (4).

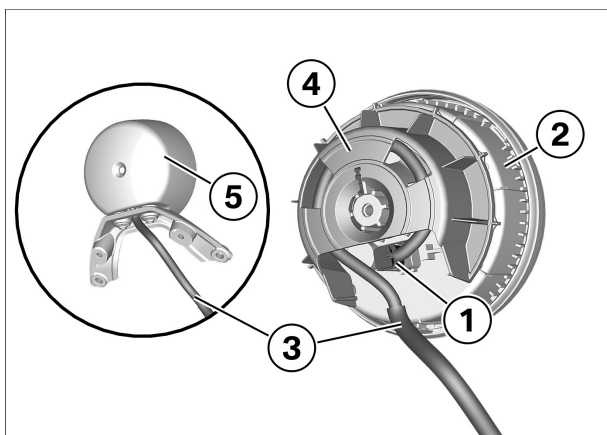

- Disconnect connector (1) for instrument cluster (2) and work cable (3) clear from internal holder (4) and instrument pan (5).
- Take off instrument cluster (2), internal holder (4) and instrument pan (5).

4

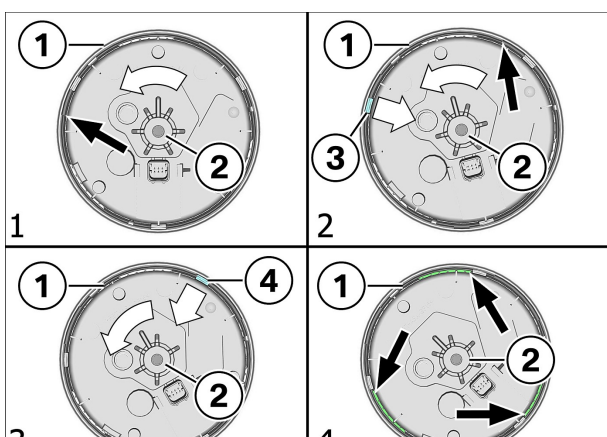

► Removing chrome ring from instrument cluster

- Step 1:
 - Hold chrome ring (1) and turn instrument cluster (2) in counterclockwise direction to noticeable stop (arrow).
- Step 2:
 - Press stop (3) with suitable tool in the direction of the instrument centre point and turn instrument cluster (2) repeatedly in counterclockwise direction until another stop (arrow) can be felt.
- Step 3:
 - Press stop (4) with suitable tool in the direction of the instrument centre point and turn instrument cluster (2) repeatedly in counterclockwise direction.
- Step 4:
 - After reaching the three end stops (arrows) the chrome ring (1) can be detached.

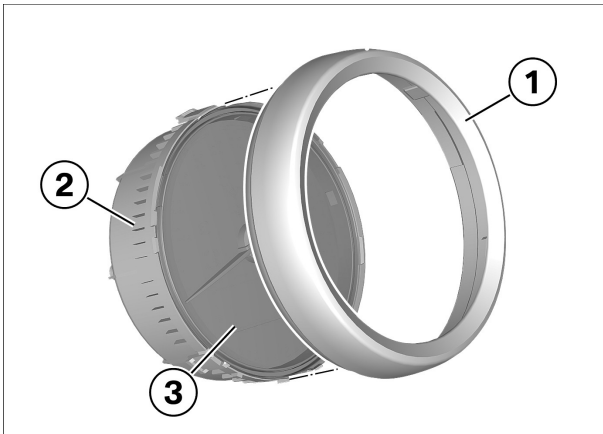

- Remove chrome ring (1) from instrument cluster (2). Hold instrument glass (3) in position on instrument cluster (2). Instrument glass (3) is only placed loosely without the chrome ring (1)!

5

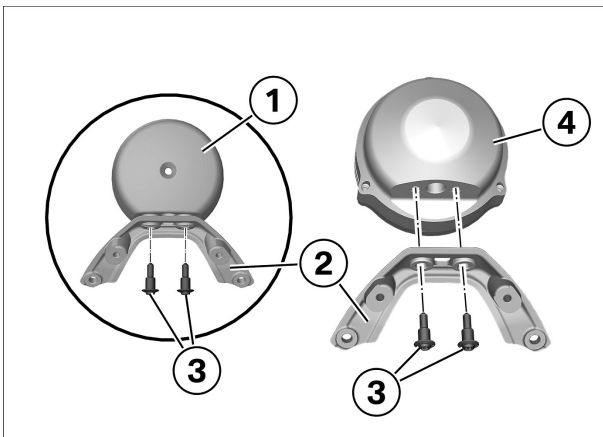

► Remounting holder for instrument cluster

- Remove screws (3) from holder (2) and housing (1).
- Position holder (2) on housing (4).
- Install screws (3) in holder (2) and housing (4).

Tightening torques		
Holder to instrument cluster housing		
M5	2 Nm	

6

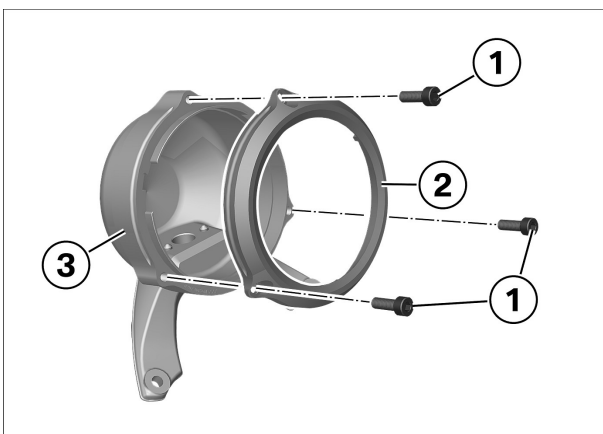

► Disassembling housing for instrument cluster

- Remove screws (1).
- Remove cover (2) from housing (3) for instrument cluster.

7

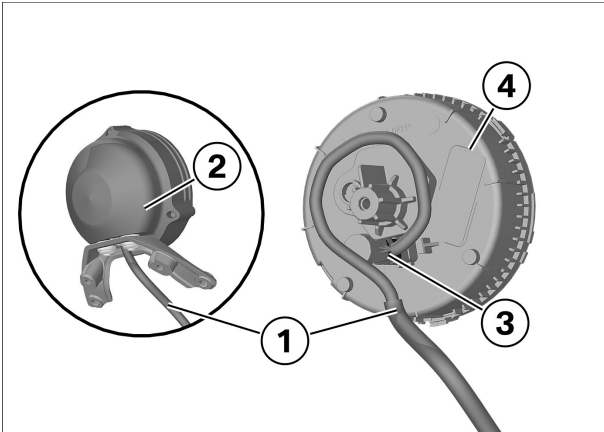

► **Installing instrument cluster**

- Thread instrument cable (1) through new housing for instrument cluster (2) and connect connector (3) to instrument cluster (4).

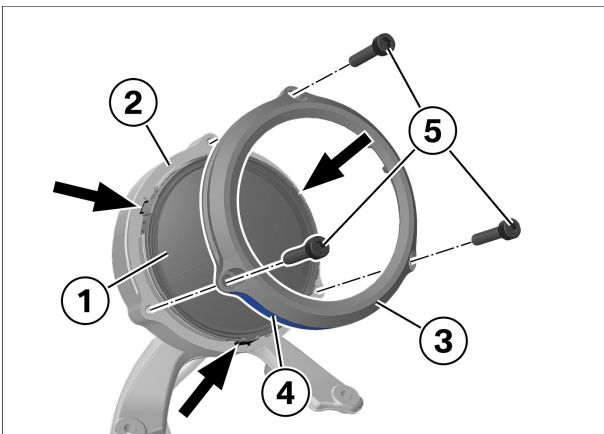

- Position instrument cluster (1) on housing for instrument cluster (2) and position stops in recesses (arrows).
- Position cover (3) on housing for instrument cluster (2) with unmilled surface (4) facing down.
- Install screws (5).

Tightening torques		
Cover to housing for instrument cluster		
M5 x 22	8 Nm	

8

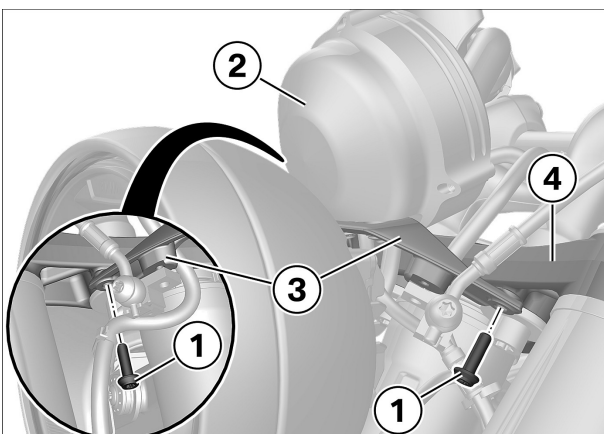

► **Securing instrument cluster with holder**

- Position instrument cluster (2) with holder (3) on fork bridge (4).
- Install screws (1).

Tightening torques		
Instrument cluster bracket to fork bridge		
M6 x 20	8 Nm	

9

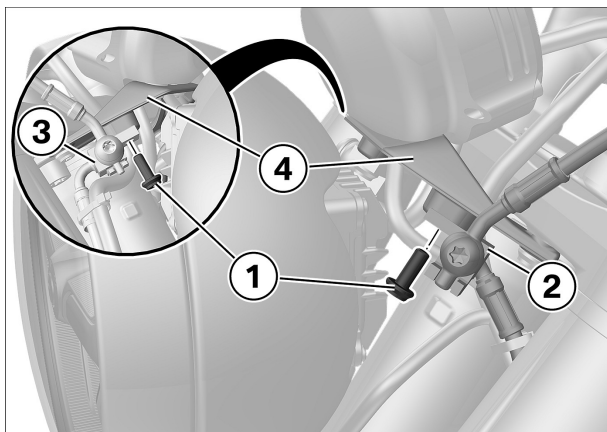
► **Securing clutch and brake line**

- Position clutch line (2) on holder (4) and secure with screw (1) aligning clutch line (2).

**Tightening torques****Clutch line to instrument holder**

M6 x 16

8 Nm

» Lines are not under tension and cannot chafe.

- Position brake line (3) on holder (4) and secure with screw (1) aligning brake line (3).

**Tightening torques****Brake line to instrument holder**

M6 x 16

8 Nm

» Lines are not under tension and cannot chafe.

10

► **Final check of work performed**

- Check the following:
 - The work as performed achieved the intended purpose.
 - All reservoirs and containers have been filled and all fluids and lubricants are at their correct levels.
 - All threaded fasteners released beforehand have been correctly retightened.
 - The fuel system is free of leaks.
 - The lights and signalling equipment are fully operational and the vehicle is roadworthy.
 - The brake pads of the front and rear brakes are bedded against the brake discs.

▷ **Function test, engine start suppression****Check**

- Select neutral.
 - » Neutral indicator light "N" lights up.
- Select a gear.
 - » Neutral indicator light "N" goes out.
- Operate the starter switch.
 - » Starter does **not** operate.
- Extend the side stand.
- Pull the clutch lever.
- Operate the starter switch.
 - » Starter does **not** operate.
- Retract the side stand.

- Operate the starter switch without releasing the clutch lever.
- » Starter operates.

Result

Not all test steps completed successfully.

Measure

- Check corresponding components with BMW Motorrad diagnosis system.

