

BMW Motorrad

Installation instructions

Cover headlight

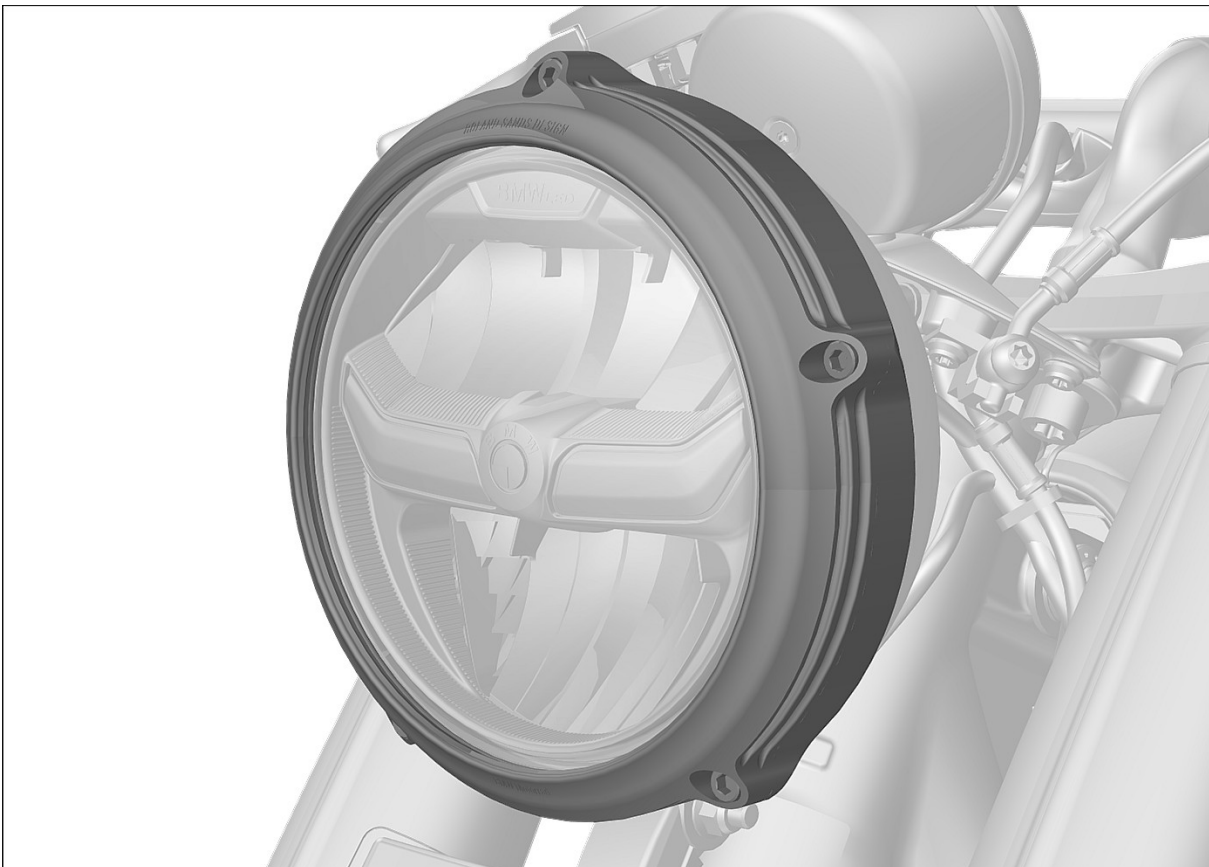

Before commencing work, you must read these installation instructions through carefully and make sure you understand them fully.

We congratulate you on your choice of optional accessories from BMW Motorrad that will enable you to customise your motorcycle in accordance with your personal preferences.

Safety is invariably an essential prerequisite for extracting full benefit and enjoyment from new accessories. Some work calls for special tools and possibly a thorough knowledge of motorcycle technology. If you are in doubt consult a specialist workshop, preferably your authorised BMW Motorrad dealer.

Since we provide you with a multitude of accessories and optional equipment, we cannot cover all equipment specifications in these installation instructions. Therefore we restrict ourselves to the basic version of the corresponding model. The removal and installation of other possibly installed accessories is described in the corresponding installation instructions. Consult your authorised BMW Motorrad dealer if you no longer have access to the sets of instructions you need.

If you have questions concerning your motorcycle or any of the accessories from our range, your authorised BMW Motorrad dealer will gladly provide advice and assistance.

We at BMW Motorrad hope you will enjoy riding your BMW and that all your journeys will be pleasant and safe.

The symbols used to draw attention to precautionary statements in this manual are as follows:



CAUTION

Low-risk hazard. Non-avoidance can lead to slight or moderate injury.



WARNING

Medium-risk hazard. Non-avoidance can lead to fatal or severe injury.



DANGER

High-risk hazard. Non-avoidance leads to fatal or severe injury.



ATTENTION

Special notes and precautionary measures. Non-compliance can lead to damage to the vehicle or accessory and, consequently, to voiding of the warranty.



NOTICE

Specific instructions on how to operate, control, adjust or look after items of equipment on the motorcycle.



Tightening torque

Screws, bolts and nuts are tightened in accordance with the applicable DIN/ISO standards. Tightening torques that deviate from the standards are stated. Non-compliance can result in damage to the vehicle or accessories or can endanger the driver.

► Start of the main activity

▷ Start of the secondary activity

• Instruction

◄ End of the main activity

◁ End of the secondary activity

◇ End of validity designation CS (construction status), OE (optional extra) or OA (optional accessory)

© 2020 Bayerische Motoren Werke Aktiengesellschaft
80788 Munich, Germany

Not to be reproduced by any means whatsoever, wholly or in part, without the written permission of BMW Motorrad, After Sales.

Printed in Germany.

Subject to change without notice. Errors and omissions excepted.

All rights reserved.

Cover headlight

Requisite tools

- Set of Torx bits
- Set of hexagon socket bits
- Torque wrench



Delivery specification

- Cover set for headlight

General instructions

ATTENTION

Vehicle not securely propped

Risk of damage to parts if vehicle topples

- Prop the vehicle securely.

WARNING

Children and pets in the working area

Injury to persons

- Keep children and pets away from the working area.

CAUTION

Wearing jewellery during work

Risk of injury by snagging or electrical short circuit

- Remove all items of personal jewellery (rings, chains, wristwatch, etc.) before starting work.

NOTICE

Once the retrofit kit has been installed by the workshop, these installation instructions must be handed over to the customer.

Make sure that these installation instructions accompany the retrofit kit when it is passed on to a third party.

77 51 009 Install cover for headlight

Additional work: 46 52 510 Removing and installing the rear-wheel stand special tool (motorcycles without centre stand)

1

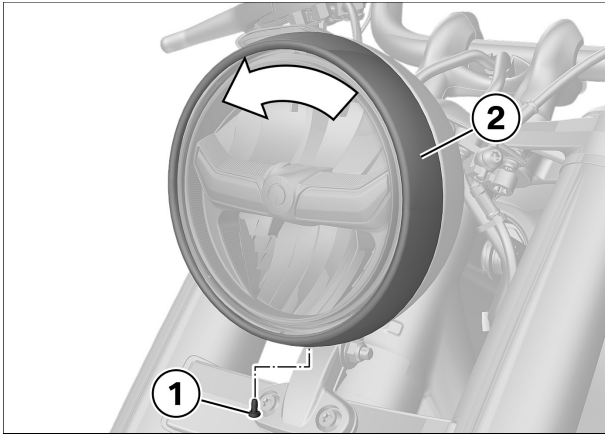

► Remove lamps ring

- Remove bolt (1).
- Turn lamp ring (2) in counterclockwise direction to the stop.

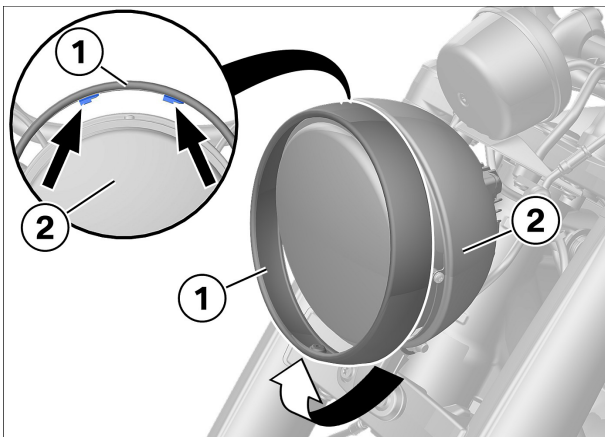

- Pivot the lamp ring (1) on the bottom to the front, detach stop (Arrows) from headlight housing (2) and remove lamp ring (1) to the top.

2

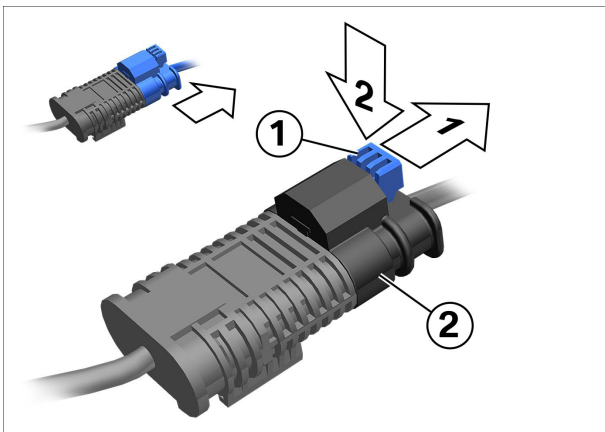

► Remove headlight with holder

▷ Information for disconnecting vibration-resistant connectors

ATTENTION

Disconnection of the connector not in compliance with correct procedure

Damage to locking tab

- Push the connector away from the locking tab, do not lift or bend the locking tab.

- Unlock locking tab (1) in direction of arrow (narrow 1).
- Press down locking tab (1) in direction of arrow (arrow 2) and disconnect connector (2).

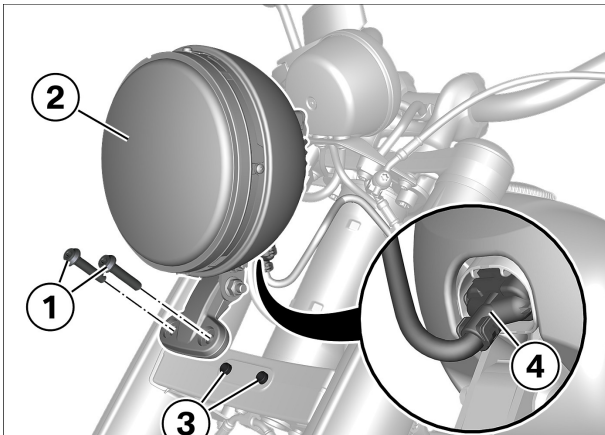

- Remove screws **(1)** and lay them safely aside, **will be re-used**.
- Detach headlight with holder **(2)**. Observe centering bush **(3)** during this operation.
- Disconnect connector **(4)** for headlight and remove headlight with holder **(2)**.

3

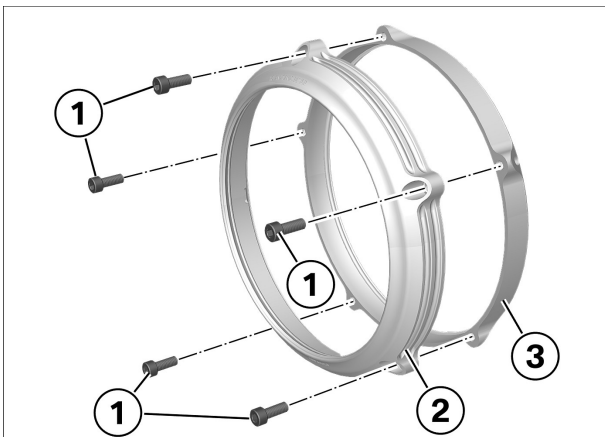

► Disassemble headlight cover

- Remove screws **(1)**.
- Remove front headlight cover **(2)** from rear headlight cover **(3)**.

4

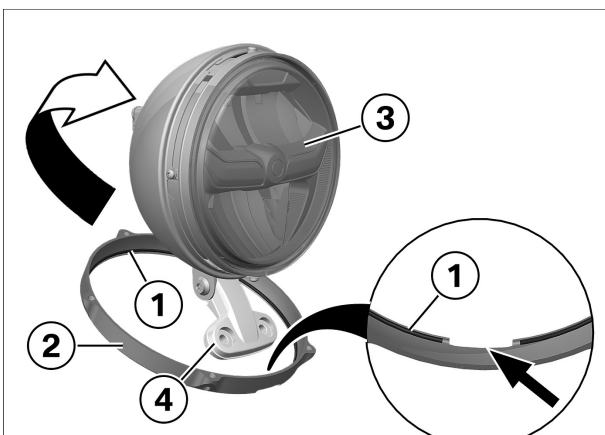

► Assemble cover for headlight rear

- Lubricate sealing ring **(1)**.



Installation tool

Silicone spray

83 19 2 208 609

- Work cover for rear headlight **(2)** from the rear bottom over headlight **(3)** and holder **(4)** and position. Ensure alignment of recess **(Arrow)** for headlight holder **(4)**.

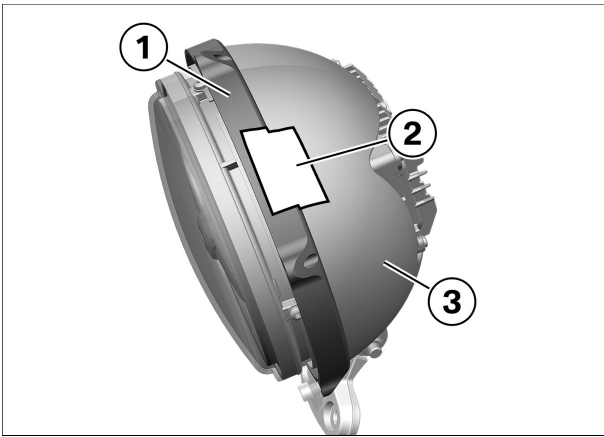

- Secure cover of rear headlight **(1)** temporarily with adhesive tape **(2)** on headlight housing **(3)**.



5

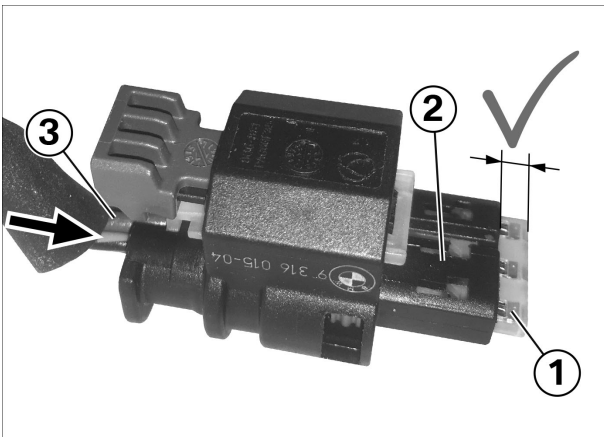

► Install headlight with holder

▷ Information for connecting vibration-resistant connectors

- Check if the contact carrier **(1)** protrudes significantly from the connector housing **(2)**.
- If necessary, hold down the connector housing **(2)** and slide contact carrier from the rear at the cable inlet **(3)** toward the front until the contact carrier **(1)** is visible

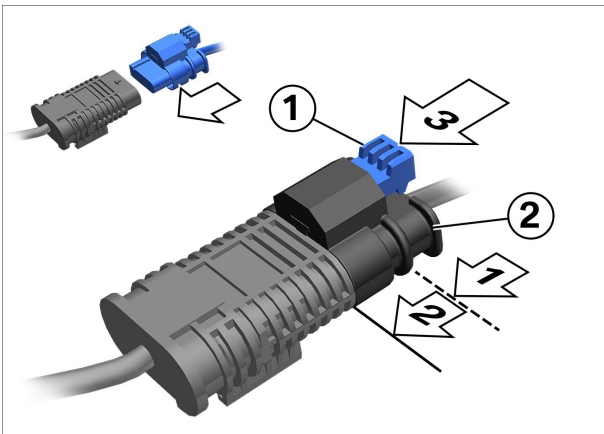

- Ensure that the release tab **(1)** is unlocked.
- Slide connector **(2)** in direction of arrow **(arrow 1)**.
 - » The connector **(2)** engages audibly.
- Slide connector **(2)** in direction of arrow **(arrow 2)** further.
 - » The connector **(2)** engages audibly.
- Slide locking tab **(1)** in direction of arrow **(arrow 3)**.
 - » The locking tab **(1)** engages audibly.



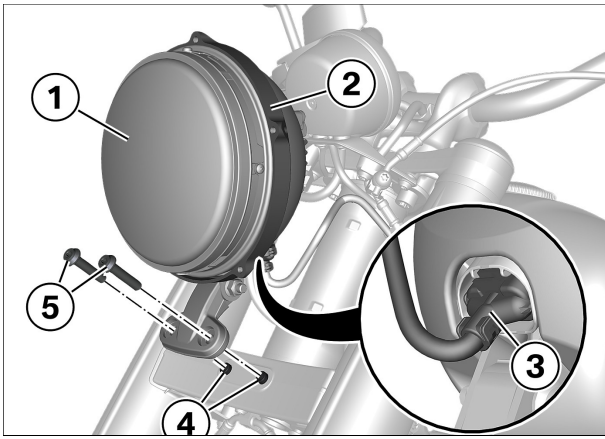

- Position headlight with holder **(1)** and rear headlight cover **(2)** and connect connector **(3)** for headlight.
- Fit headlight with holder **(1)** and rear headlight cover **(2)**. Observe centering bushes **(4)** during this operation.
- Install screws **(5)**.

 Tightening torques		
Headlight bracket mounting		
M8 x 35	19 Nm	

6

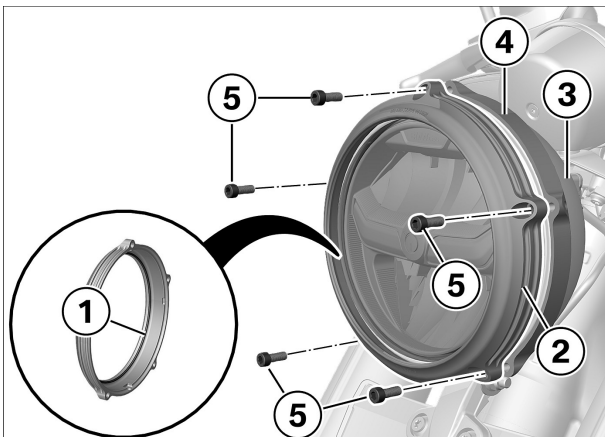

► Install front headlight cover

- Lubricate sealing ring **(1)**.

 Installation tool	
Silicone spray	83 19 2 208 609

- Position and align front headlight cover **(2)** on headlight housing **(3)** and rear headlight cover **(4)**.
- Install bolts **(5)**, do not tighten.

7

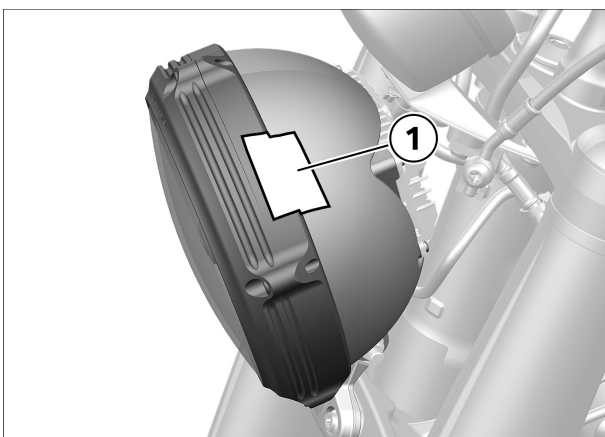

► Tighten headlight cover

- Remove the adhesive tape **(1)**.

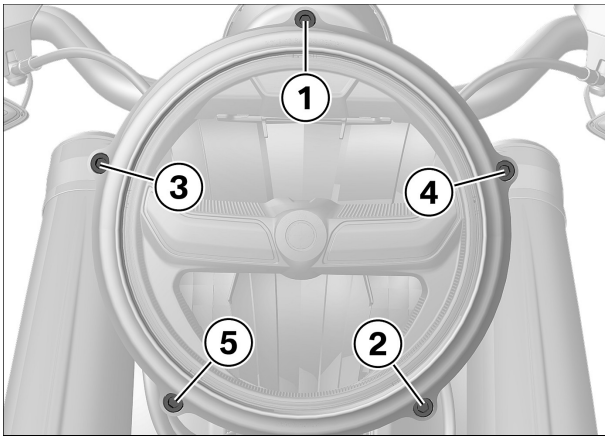

- Tighten bolts evenly in multiple operations according to the specified tightening sequence.

Tightening torques		
Front headlight cover to rear headlight cover		
M6 x 16	14 Nm	

8

► Checking headlight beam throw

Requirement

Motorcycle standing on a smooth, level surface.

Rider's weight applied to the motorcycle.

- Set the spring preload to the basic setting.
- Start the engine and check that the headlight setting.

Check

- Distances:

- (a): distance between headlight and vertical surface
- (b): height of centre of headlight
- (c): distance to light/dark cut-off

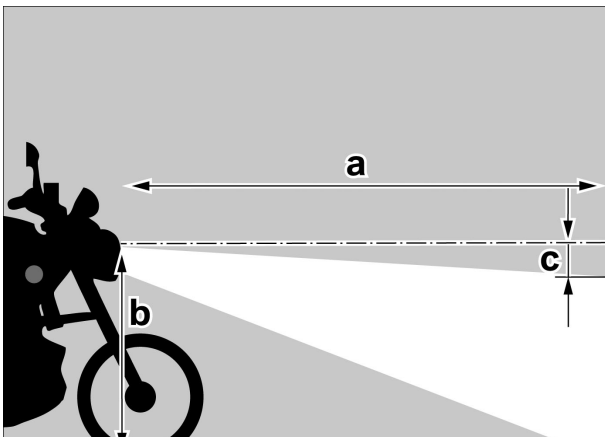

Technical data			
Distance between headlight and vertical surface For headlight adjustment		5 m	
Distance between light/dark cut-off and mark at height of centre of headlight	Suspension set to basic setting and vehicle loaded with 85 kg	5 cm	

Result

Headlight beam angle not correct.

Measure

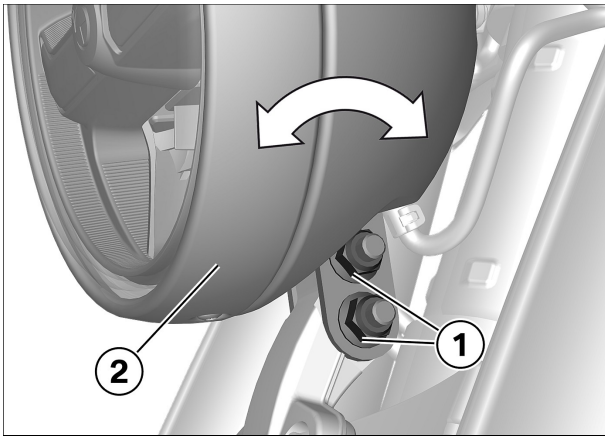

▶ Correcting headlight beam angle

- Slacken nuts **(1)** and adjust headlight beam throw by pivoting the headlight **(2)**.
- Tighten screws **(1)**.

🔧 Tightening torques		
Headlight to bracket		
M8 x 40	19 Nm	



9

▶ Final check of work performed

- Check the following:
 - The work as performed achieved the intended purpose.
 - All reservoirs and containers have been filled and all fluids and lubricants are at their correct levels.
 - All threaded fasteners released beforehand have been correctly retightened.
 - The fuel system is free of leaks.
 - The lights and signalling equipment are fully operational and the vehicle is roadworthy.
 - The brake pads of the front and rear brakes are bedded against the brake discs.

▶ Function test, engine start suppression

Check

- Select neutral.
 - » Neutral indicator light "N" lights up.
- Select a gear.
 - » Neutral indicator light "N" goes out.
- Operate the starter switch.
 - » Starter does **not** operate.
- Extend the side stand.
 - » Starter does **not** operate.
- Pull the clutch lever.
 - » Starter does **not** operate.
- Operate the starter switch.
 - » Starter does **not** operate.
- Retract the side stand.
 - » Starter does **not** operate.
- Operate the starter switch without releasing the clutch lever.
 - » Starter operates.

Result

Not all test steps completed successfully.

Measure

- Check the appropriate parts with the BMW Motorrad diagnostic system.

