

# BMW Motorrad

## Installation instructions

### Brake lever protector



**Before commencing work, you must read these installation instructions through carefully and make sure you understand them fully.**

We congratulate you on your choice of optional accessories from BMW Motorrad that will enable you to customise your motorcycle in accordance with your personal preferences.

Safety is invariably an essential prerequisite for extracting full benefit and enjoyment from new accessories. Some work calls for special tools and possibly a thorough knowledge of motorcycle technology. If you are in doubt consult a specialist workshop, preferably your authorised BMW Motorrad dealer.

Since we provide you with a multitude of accessories and optional equipment, we cannot cover all equipment specifications in these installation instructions. Therefore we restrict ourselves to the basic version of the corresponding model. The removal and installation of other possibly installed accessories is described in the corresponding installation instructions. Consult your authorised BMW Motorrad dealer if you no longer have access to the sets of instructions you need.

If you have questions concerning your motorcycle or any of the accessories from our range, your authorised BMW Motorrad dealer will gladly provide advice and assistance.

We at BMW Motorrad hope you will enjoy riding your BMW and that all your journeys will be pleasant and safe.

**The symbols used to draw attention to precautionary statements in this manual are as follows:**



Low-risk hazard. Non-avoidance can lead to slight or moderate injury.



Medium-risk hazard. Non-avoidance can lead to fatal or severe injury.



High-risk hazard. Non-avoidance leads to fatal or severe injury.



Special notes and precautionary measures. Non-compliance can lead to damage to the vehicle or accessory and, consequently, to voiding of the warranty.



Specific instructions on how to operate, control, adjust or look after items of equipment on the motorcycle.



Screws, bolts and nuts are tightened in accordance with the applicable DIN/ISO standards. Tightening torques that deviate from the standards are stated. Non-compliance can result in damage to the vehicle or accessories or can endanger the driver.

- ▶ Start of the main activity
- ▷ Start of the secondary activity
- Instruction

- ◀ End of the main activity
- ◁ End of the secondary activity
- ◇ End of validity designation CS (construction status), OE (optional extra) or OA (optional accessory)

© 2020 Bayerische Motoren Werke Aktiengesellschaft  
80788 Munich, Germany

Not to be reproduced by any means whatsoever, wholly or in part, without the written permission of BMW Motorrad, After Sales.  
Printed in Germany.

Subject to change without notice. Errors and omissions excepted.  
All rights reserved.

# Brake lever protector

## Requisite tools

- Set of external socket bits
- Set of Torx bits
- Torque wrench



## Delivery specification

- Brake lever protector
- Handlebar weight
- Screw , M8 x 40

## General instructions

### ATTENTION

#### Vehicle not securely propped

Risk of damage to parts if vehicle topples

- Prop the vehicle securely.

### WARNING

#### Children and pets in the working area

Injury to persons

- Keep children and pets away from the working area.

### CAUTION

#### Wearing jewellery during work

Risk of injury by snagging or electrical short circuit

- Remove all items of personal jewellery (rings, chains, wristwatch, etc.) before starting work.

### NOTICE

Once the retrofit kit has been installed by the workshop, these installation instructions must be handed over to the customer.

Make sure that these installation instructions accompany the retrofit kit when it is passed on to a third party.

## 77 22 007 Installing brake lever protector for brake lever

Additional work: 46 52 510 Removing and installing the rear-wheel stand special tool (motorcycles without centre stand)

1

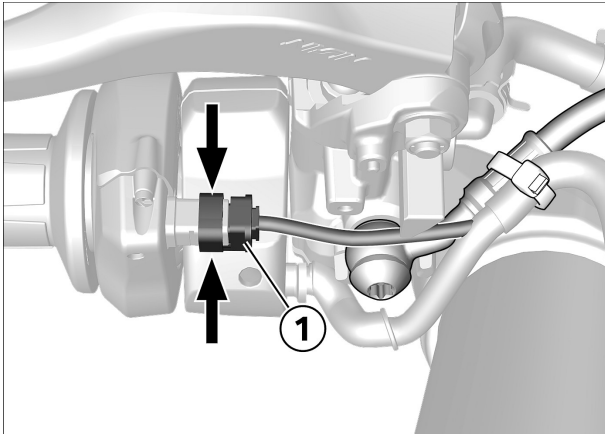

### ► Removing right multifunction switch

#### ▷ Disconnecting plug for throttle grip

- Press top and bottom unlockings (**Arrows**) and disconnect connector **(1)** for throttle grip.

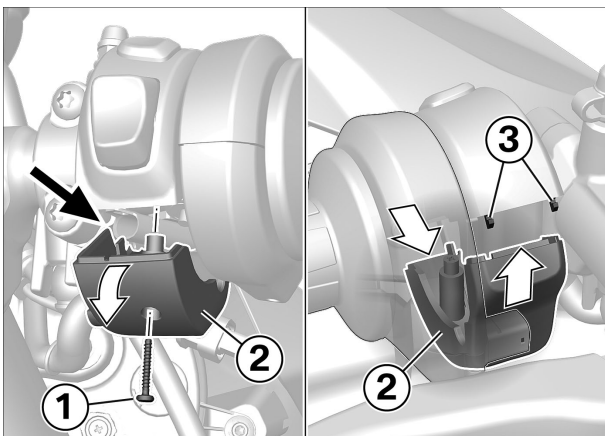

- Remove bolt **(1)**.
- Ease cover **(2)** down slightly until the multifunction switch is open (**arrow**).
- Push cover **(2)** forward and up to remove, noting **retaining tabs (3)**.

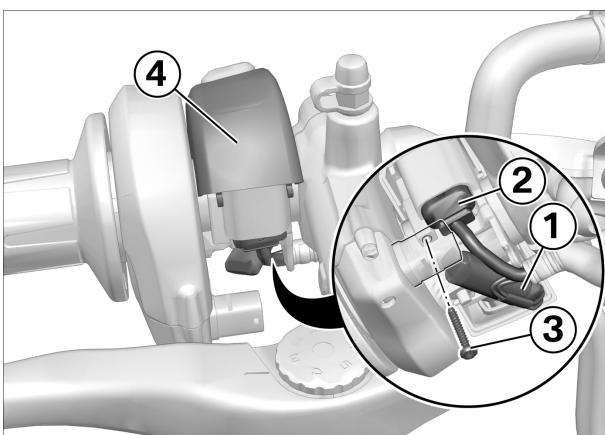

- Unclip 2-pin connector **(1)** with blind cap.
- Disconnect connector **(2)** for the multifunction switch.
- Remove bolt **(3)**.
- Remove multifunction switch **(4)**.

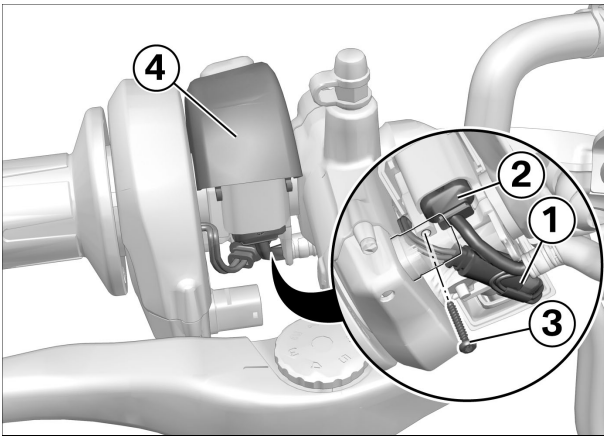

- with heated grips<sup>OE</sup> (0519)
- Unclip connector **(1)** for grip heating and disconnect.
- Disconnect connector **(2)** for the multifunction switch.
- Remove bolt **(3)**.
- Remove multifunction switch **(4)**.◇



## 2

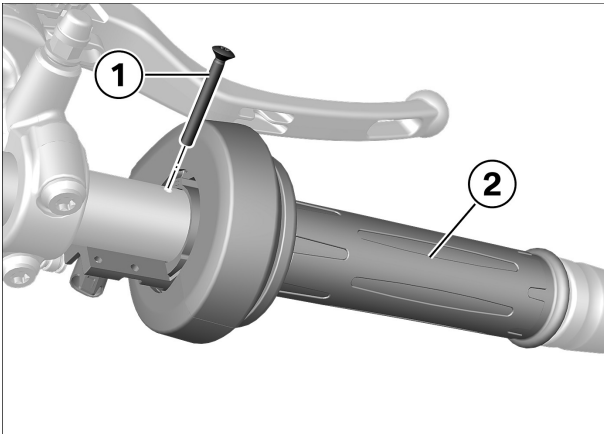

### ► Disengaging throttle twistgrip

- Remove bolt **(1)**.
- Release throttle grip **(2)** and slide to the side.



## 3

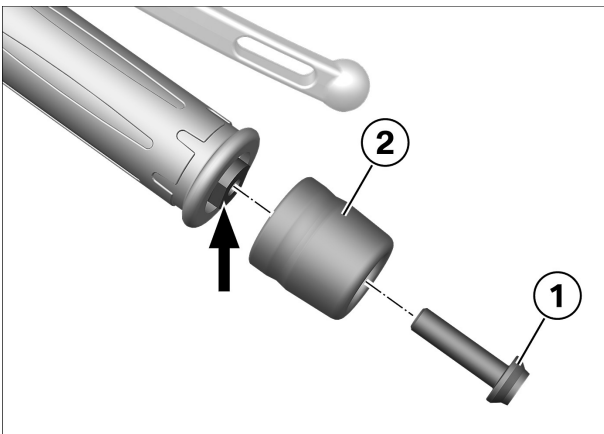

### ► Remove the right handlebar weight

- Remove bolt **(1)** bracing on mounting flats **(arrow)**.
- Remove handlebar weight **(2)**.



## ► Installing the brake lever protector

### **⚠ WARNING**

**Impaired operation of brake lever and throttle twist-grip due to installation of brake-lever protector not in compliance with correct procedure**

Risk of falling

- When installing, make sure that the brake lever can be operated correctly and that nothing obstructs the action of the throttle twistgrip.

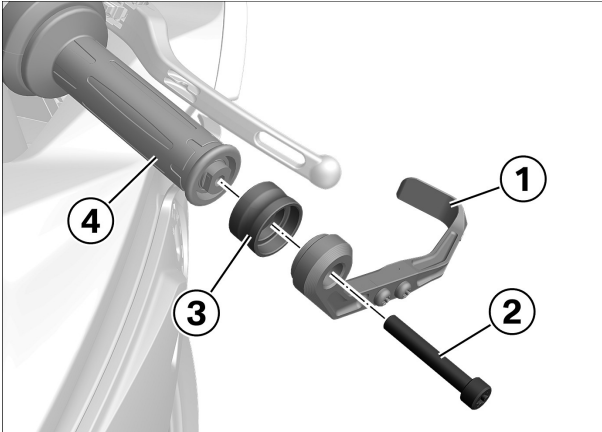

- Install brake lever protector (1) with bolt (2) and handlebar weight (3) in handlebar (4) hand-tight.

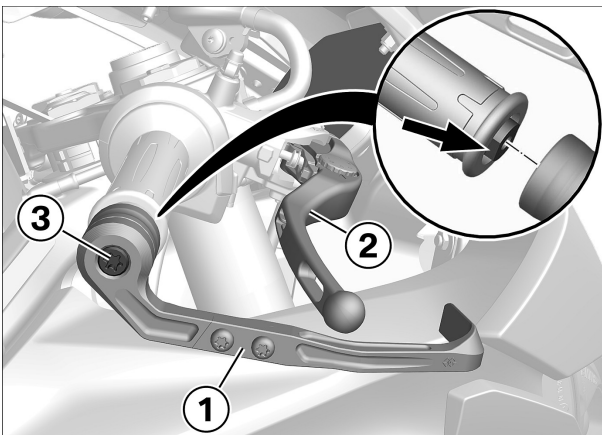

- Align brake lever protector (1) with position of brake lever (2).
- Tighten bolt (3), bracing on mounting flats (arrow).

 <b>Tightening torques</b>		
<b>Brake/clutch lever protector on handlebars</b>		
M8 x 40	20 Nm	

# 5

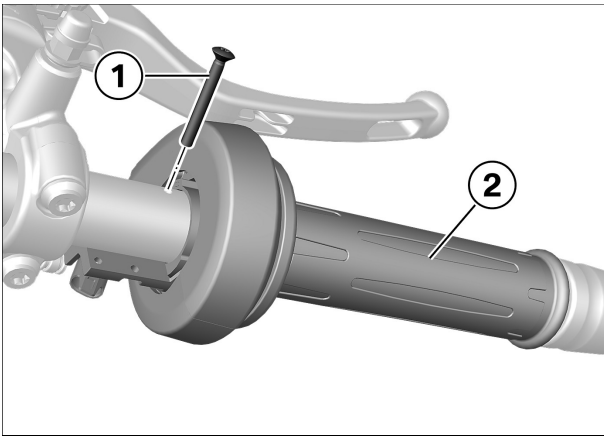

## ► Securing throttle twistgrip

- Position throttle grip (2).
- Install bolt (1).

Tightening torques		
Throttle twistgrip to handlebar		
M3.5 x 30	2 Nm	

# 6

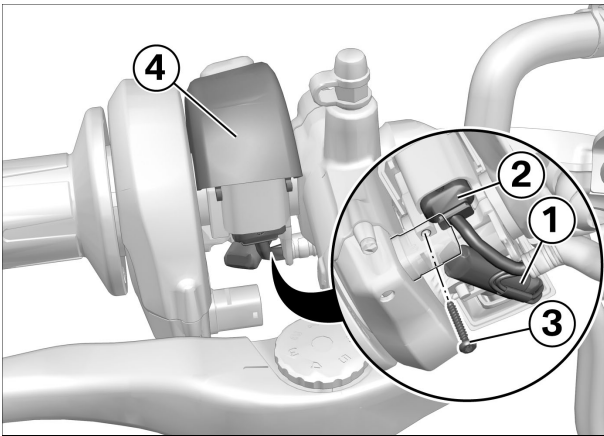

## ► Installing right multifunction switch

- Hold the multifunction switch (4) in position.

### ATTENTION

**Screws overtightened past the specified value**  
Component damage

- Tighten the screws only to their specified tightening torque.

- Install bolt (3).

Tightening torques		
Right multifunction switch to throttle grip		
Screw for plastic, PT2.5 x 15	0.5 Nm	

- Connect connector (2) for the multifunction switch.
- Clip in the 2-pin connector to (1) using blind cap.

– with heated grips<sup>OE</sup> (0519)

- Hold the multifunction switch (4) in position.

### ATTENTION

**Screws overtightened past the specified value**  
Component damage

- Tighten the screws only to their specified tightening torque.

- Install bolt (3).

Tightening torques		
Right multifunction switch to throttle grip		
Screw for plastic, PT2.5 x 15	0.5 Nm	

- Connect connector (2) for the multifunction switch.

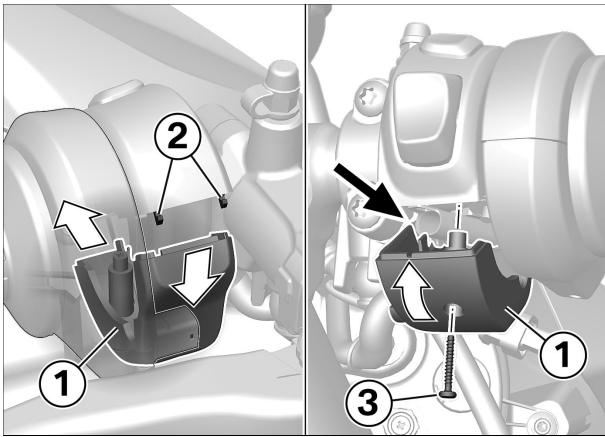

- Connect connector **(1)** for the heated grip and clip it into position.◇
- Position cover **(1)** and push backwards and down, paying attention to **retaining catches(2)**.
- Push cover **(2)** upwards until the multifunction switch is closed.

### **ATTENTION**

#### **Screws overtightened past the specified value**

Component damage

- Tighten the screws only to their specified tightening torque.

- Install bolt **(3)**.

#### **Tightening torques**

##### **Cover to right multifunction switch**

Screw for plastic, PT2.5 x 15	0.5 Nm	
----------------------------------	--------	--

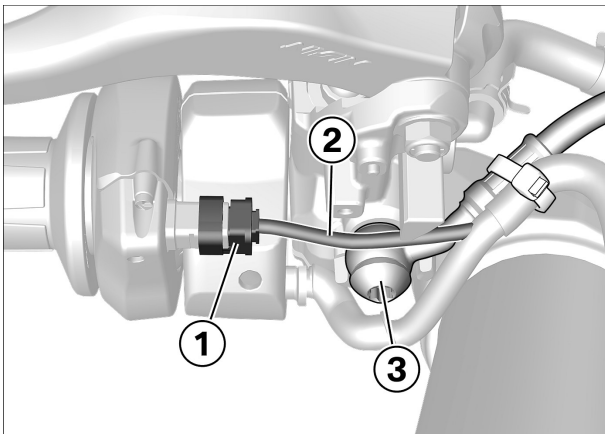

#### ▷ **Connect the plug for throttle grip**

- Connect the plug connection **(1)** for throttle grip. Make sure that cable **(2)** for the throttle grip is **routed in front of brake line(3)**.



## 7

#### ▶ **Final check of work performed**

- Check the following:
  - The work as performed achieved the intended purpose.
  - All reservoirs and containers have been filled and all fluids and lubricants are at their correct levels.
  - All threaded fasteners released beforehand have been correctly retightened.
  - The fuel system is free of leaks.
  - The lights and signalling equipment are fully operational and the vehicle is roadworthy.
  - The brake pads of the front and rear brakes are bedded against the brake discs.

#### ▷ **Function test, engine start suppression**

##### **Check**

- Set kill switch to "ON" position.



- Select neutral.
- Switch on the ignition.
  - » Neutral indicator light "N" lights up.
- Select a gear.
  - » Neutral indicator light "N" goes out.
- Press the starter button.
  - » Starter does **not** operate.
- Extend the side stand.
- Pull the clutch lever.
- Press the starter button.
  - » Starter does **not** operate.
- Retract the side stand.
- Press the starter button without releasing the clutch lever.
  - » Starter operates.

**Result**

Not all test steps completed successfully.

**Measure**

- Check the appropriate parts with the BMW Motorrad diagnostic system.

